



**CONSENT AGENDA  
DRAINAGE DISTRICT  
BOARD OF DIRECTORS  
September 9, 2014  
9:00 A.M.**

**NOTICE is hereby given in accordance with Chapter 551, Texas Government Code, that a SPECIAL MEETING of the Drainage District #1 Board of Directors will be held at the Edinburg Council Chambers 415 W. University Drive, Edinburg, Hidalgo County, Texas. Discussion and possible action relating to the following business will be transacted:**

**NOTICE TO THE PUBLIC  
CONSENT AGENDA**

**The following items are of a routine or administrative nature. The Drainage District #1 Board has been furnished with background and support on each item, and/or it has been discussed at a previous meeting. All items will be acted upon by one vote without being discussed separately unless requested by a Board Member, in which event the item or items will immediately be withdrawn for individual consideration in its normal sequence after the items not requiring separate discussion have been acted upon. The remaining items will be adopted by one vote.**

1. Approval of check register and payment of claims and bills - County Treasurer

2. **AI-46250** Discharge Permit  
Kyndel W Bennett - Juliway Estates

3. **AI-46321** Discharge Permit:  
Kyndel W. Bennett - Magdalena Estates

4. **AI-46328** **Request approval to issue payment on the following items after review & audit procedures have been completed:**

**2008 Bonds:**

Inv. no. 20142033 in the amount of \$6,944.99 from Tedsi Infrastructure Group pertaining to Work Authorization no. 9-GLO Review East Lateral Drain

**2013 Bonds:**

Inv. no. 11324908 in the amount of \$74,212.76 from L&G Consulting Engineers, Inc. pertaining to Work Authorization no. 4-Mission Inlet Recertification Project. PO#624010

Inv. no. 3663 in the amount of \$259.33 from R. Gutierrez Engineering Corp. pertaining to Work Authorization no. 3-Pct.2 Rural Drainage Development. PO#624631-R.

Inv. no. U2167-01 in the amount of \$55,403.79 from S&B Infrastructure, LTD. pertaining to Work Authorization no. 1-3-Repairs to Weir no. 4-Main

Floodwater Channel. PO#624678, 624679 & 624680.

Inv. no. U2167-02 in the amount of \$6,501.98 from S&B Infrastructure, LTD pertaining to Work Authorization no. 1-3-Repairs to Weir no. 4-Main Floodwater Channel. PO#624678, 624679 & 624680.

Inv. no. 20142034 in the amount of \$998.05 from Tedsy Infrastructure Group pertaining to Work Authorization no. 10-Pct.1 Rural Drainage Development-Adams Black Colonia. PO#623574-14.

Inv. no. 0060330 in the amount of \$2,110.05 from Melden & Hunt, Inc. pertaining to Work Authorization no. 1-Rado Drain Rehabilitation. PO#622613-14 & 622596-14.

5. **AI-46382** Approval of Budget Line Item transfers by Object within of the 2013 Bond Series

**AI-46250**

**2.**

**DRAINAGE - CONSENT**

**Meeting Date:** 09/09/2014

Submitted By: Sylvia Sanchez, DRAINAGE  
DISTRICT

Department: DRAINAGE DISTRICT

---

**Information**

**CAPTION**

Discharge Permit  
Kyndel W Bennett - Juliway Estates

**BACKGROUND**

---

**Form Review**

<b>Inbox</b>	<b>Reviewed By</b>	<b>Date</b>
Budget & Management	Debbie Tamez	08/29/2014 04:14 PM
Final Approval	Monica Badillo	09/05/2014 05:45 PM
Form Started By: Sylvia Sanchez		Started On: 08/29/2014 03:51 PM
	Final Approval Date: 09/05/2014	

**AI-46321**

**3.**

**DRAINAGE - CONSENT**

**Meeting Date:** 09/09/2014

Submitted By: Sylvia Sanchez, DRAINAGE  
DISTRICT

Department: DRAINAGE DISTRICT

---

**Information**

**CAPTION**

Discharge Permit:  
Kyndel W. Bennett - Magdalena Estates

**BACKGROUND**

---

**Form Review**

<b>Inbox</b>	<b>Reviewed By</b>	<b>Date</b>
Budget & Management	Debbie Tamez	09/04/2014 08:33 AM
Final Approval	Monica Badillo	09/05/2014 05:45 PM
Form Started By: Sylvia Sanchez		Started On: 09/04/2014 08:25 AM
	Final Approval Date: 09/05/2014	

AI-46328

4.

**DRAINAGE - CONSENT**

**Meeting Date:** 09/09/2014

Submitted By: Claudette Guerrero, DRAINAGE  
DISTRICT

Department: DRAINAGE DISTRICT

---

Information

CAPTION

**Request approval to issue payment on the following items after review & audit procedures have been completed:**

**2008 Bonds:**

Inv. no. 20142033 in the amount of \$6,944.99 from Tedsi Infrastructure Group pertaining to Work Authorization no. 9-GLO Review East Lateral Drain

**2013 Bonds:**

Inv. no. 11324908 in the amount of \$74,212.76 from L&G Consulting Engineers, Inc. pertaining to Work Authorization no. 4-Mission Inlet Recertification Project. PO#624010

Inv. no. 3663 in the amount of \$259.33 from R. Gutierrez Engineering Corp. pertaining to Work Authorization no. 3-Pct.2 Rural Drainage Development. PO#624631-R.

Inv. no. U2167-01 in the amount of \$55,403.79 from S&B Infrastructure, LTD. pertaining to Work Authorization no. 1-3-Repairs to Weir no. 4-Main Floodwater Channel. PO#624678, 624679 & 624680.

Inv. no. U2167-02 in the amount of \$6,501.98 from S&B Infrastructure, LTD pertaining to Work Authorization no. 1-3-Repairs to Weir no. 4-Main Floodwater Channel. PO#624678, 624679 & 624680.

Inv. no. 20142034 in the amount of \$998.05 from Tedsi Infrastructure Group pertaining to Work Authorization no. 10-Pct.1 Rural Drainage Development-Adams Black Colonia. PO#623574-14.

Inv. no. 0060330 in the amount of \$2,110.05 from Melden & Hunt, Inc. pertaining to Work Authorization no. 1-Rado Drain Rehabilitation. PO#622613-14 & 622596-14.

BACKGROUND

---

Attachments

Melden Inv#60330

Teds Inv#20142033

Teds Inv#20142034

S&B Inv#U2167-01

S&B Inv#U2167-02

R. GTZ Inv#3663

L&G Inv#11324908

Form Review

<b>Inbox</b>	<b>Reviewed By</b>	<b>Date</b>
Budget & Management	Debbie Tamez	09/04/2014 01:30 PM
Final Approval	Monica Badillo	09/05/2014 05:45 PM
Form Started By: Claudette Guerrero		Started On: 09/04/2014 10:01 AM
	Final Approval Date: 09/05/2014	

# HIDALGO COUNTY DRAINAGE DISTRICT NUMBER ONE

912 NORTH DOOLITTLE

EDINBURG, TEXAS 78542

(956) 292-7080

FAX (956) 292-7089

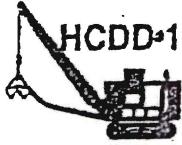

GODFREY GARZA, JR.  
MANAGER

## INVOICE PROCESSING CHECKLIST

Date Received: Aug. 19, 2014

Engineer/Firm Name: Melden & Hunt Inc.

Project Name/Number: RAD Drain Proj

Invoice No: # 60330

Logged in and Scanned: 12 PM 8/19 By: Rosa Arce Forwarded to: Joey Garza

Engineer	Name	Date	Comment
Scope of work reviewed			

Accounting	Name	Date	Comment
Encumbrance			
Purchase Order Attached			
Audit			
Final Approval for Agenda			

	Name	Date	Comment
Placed on Agenda			

Additional Comments: \_\_\_\_\_

\_\_\_\_\_

\_\_\_\_\_

\_\_\_\_\_

<b>7129.02</b>				July	2014	
				<b>Invoice 60330</b>		
Billing Phase	Fee	Prior Fee	Percent Complete	Current Fee	Earned	
Eval of Alt/Prel. Eng Report	30,118.90	30,118.90	100.00		30,118.90	
Design Engineering	180,713.38	180,713.38	100.00		180,713.38	
Bidding/Recommendations	15,059.45	15,059.45	100.00		15,059.45	
Const. Eng. Derv/Proj.Perfor	75,297.24	66,261.57	90.00	<b>1,505.95</b>	67,767.52	
Reimbursables	0.00		0.00		0.00	
<b>Totals</b>	<b>301,188.97</b>	<b>292,153.30</b>		<b>1,505.95</b>	<b>293,659.25</b>	
<b>7129.01</b>						
Billing Phase	Fee	Prior Fee	Percent Complete	Current Fee	Earned	
Geotech	25,000.00	25,000.00	100.00	0.00	25,000.00	
Surveying Services (.09)	16,732.72	16,732.72	100.00	0.00	16,732.72	
Res. Project Inspection	85,867.33	0.00	0.00	0.00	0.00	
Const. Material Testing	25,000.00	1,750.00	7.00		1,750.00	
Reimbursables	0.00	0.00	0.00		0.00	
	152,600.05	43,482.72		0.00	43,482.72	
<b>7129.16</b>						
(Billed Hourly as per Contract)			Current Hours	Total Amount		
			8.50	604.10		
<b>Total This Invoice</b>				<b>2,110.05</b>		

**RECEIVED**  
 HIDALGO COUNTY  
 DRAINAGE DISTRICT #1

AUG 19 2014

11:45 (AM) PM

BY: Rosa Arce

**Invoice**

**MELDEN & HUNT, INC.**  
**Consulting Engineers**  
**115 West McIntyre**  
**Edinburg, Texas 78541**

Hidalgo County Drainage District #1  
 Attention: Godfrey Garza  
 902 N. Doolittle  
 Edinburg, TX 78541

July 31, 2014  
 Project No: 07129.02  
 Invoice No: 0060330

Project 07129.02 HCDD#1-RADO Drain Pct 2- Basic Services  
 Rado Drain Pct 2 - Basic Services. P.O. #622613.

**Professional Services from July 01, 2014 to July 31, 2014**

**Fee**

Billing Phase	Fee	Percent Complete	Earned	
Eval. of Alt/ Prel. Eng. Report	30,118.90	100.00	30,118.90	
Design Engineering	180,713.38	100.00	180,713.38	
Bidding/ Recommendations	15,059.45	100.00	15,059.45	
Const. Eng. Serv/Proj. Performance	75,297.24	90.00	67,767.52	
Reimbursables	0.00	0.00	0.00	
<b>Total Fee</b>	<b>301,188.97</b>		<b>293,659.25</b>	
			Previous Fee Billing	292,153.30
			Current Fee Billing	1,505.95
	<b>Total Fee</b>			<b>1,505.95</b>
		<b>Total this Project</b>		<b>\$1,505.95</b>

**Billings to date**

	Current	Prior	Total
Fee	1,505.95	292,153.30	293,659.25
Expense	0.00	17.00	17.00
<b>Total</b>	<b>1,505.95</b>	<b>292,170.30</b>	<b>293,676.25</b>

Project 07129.01 HCDD#1 -RADO Drain Pct. 2 - Special Serv  
 Rado Drain Pct. 2 - Special Services. P.O. #622596.

**Fee**

Billing Phase	Fee	Percent Complete	Earned	
Geotech	25,000.00	100.00	25,000.00	
Surveying Services (.09)	16,732.72	100.00	16,732.72	
Resident Proj. Inspection (.16)	85,867.33	0.00	0.00	
Const. Material Testing	25,000.00	7.00	1,750.00	
Reimbursables	0.00	0.00	0.00	
<b>Total Fee</b>	<b>152,600.05</b>		<b>43,482.72</b>	
			Previous Fee Billing	43,482.72
			Current Fee Billing	0.00
	<b>Total Fee</b>			<b>0.00</b>
		<b>Total this Project</b>		<b>0.00</b>

**Billings to date**

Project	07129.02	HCDD#1-RADO Drain Pct 2- Basic Services	Invoice	0060330
---------	----------	---	---------	---------

	Current	Prior	Total
Fee	0.00	43,482.72	43,482.72
<b>Total</b>	<b>0.00</b>	<b>43,482.72</b>	<b>43,482.72</b>

-----

Project 07129.16 HCDD#1-twin 115-in CMP, RADO Drain  
 Rado Drain Pct 2 - Inspections Services as per contract rates.

**Professional Personnel**

	Hours	Amount
Totals	8.50	604.10
<b>Total Labor</b>		<b>604.10</b>
<b>Total this Project</b>		<b>\$604.10</b>

**Billings to date**

	Current	Prior	Total
Labor	604.10	6,787.19	7,391.29
<b>Total</b>	<b>604.10</b>	<b>6,787.19</b>	<b>7,391.29</b>
<b>Total this Invoice</b>			<b>\$2,110.05</b>

**Outstanding Invoices**

Number	Date	Balance
0059958	5/31/2014	19,996.97
0060151	6/30/2014	10,428.27
<b>Total</b>		<b>30,425.24</b>
<b>Total Now Due</b>		<b>\$32,535.29</b>

**RECEIVED**  
 HIDALGO COUNTY  
 DRAINAGE DISTRICT #1

AUG 19 2014

11:45 AM/PM

BY: Rosa Arce

# Labor Detail

Tuesday, August 19, 2014  
8:54:23 AM

MELDEN & HUNT, INC.

Transactions for 7/2014 through 7/2014

		Date	Regular Hours	Total Ovt Hrs	Total Hours	Regular Billing	Tot. Ovt Billing	Total Billing
<b>Project Number: 07129.16 HCDD#1-twin 115-in CMP, RADO Drain</b>								
<b>Labor Code Level 1: 06 Construction Administration</b>								
<b>Labor Code Level 2: 126 Inspection / Reports</b>								
00236	VELA, JUAN	7/1/2014	1.00		1.00	71.07		71.07
00236	VELA, JUAN	7/9/2014	1.00		1.00	71.07		71.07
00236	VELA, JUAN	7/11/2014	1.00		1.00	71.07		71.07
00236	VELA, JUAN	7/14/2014	1.00		1.00	71.07		71.07
00236	VELA, JUAN	7/22/2014	1.00		1.00	71.07		71.07
00236	VELA, JUAN	7/24/2014	1.00		1.00	71.07		71.07
00236	VELA, JUAN	7/29/2014	1.00		1.00	71.07		71.07
00236	VELA, JUAN	7/31/2014	1.00		1.00	71.07		71.07
<b>Total for 126</b>			<b>8.00</b>		<b>8.00</b>	<b>568.56</b>		<b>568.56</b>
<b>Labor Code Level 2: 128 Pay Estimate Certification</b>								
00236	VELA, JUAN	7/15/2014	.50		.50	35.54		35.54
<b>Total for 06</b>			<b>8.50</b>		<b>8.50</b>	<b>604.10</b>		<b>604.10</b>
<b>Total for 07129.16</b>			<b>8.50</b>		<b>8.50</b>	<b>604.10</b>		<b>604.10</b>

**FIELD PROJECT REPORT**

REPORT: 98     MON     TUE     WED     TH     FRI    DATE: 07-01-14

**Project Information**

PROJECT: *RADO Storm Sewer Rehab*    DAYS USED IN CONTRACT: \_\_\_\_\_

OWNER: *Hidalgo County Drainage District*    MHI JOB # 07129.16

CONTRACTOR: *Inland Pipe Rehab South Central / REIM*

WEATHER    TEMPERATURES: 97    CONDITION

CLEAR     CLOUDY     PARTLY CLOUDY     RAIN     DRY     DAMP     MUDDY     OVERCAST

**CLASSIFICATION OF WORKMEN ON THE PROJECT**

<input checked="" type="checkbox"/> SITEWORK	<input type="checkbox"/> CONCRETE	<input type="checkbox"/> MASONRY	<input type="checkbox"/> REBAR
<input type="checkbox"/> WOOD AND PLASTICS	<input type="checkbox"/> THERMAL MOISTURE PRO	<input type="checkbox"/> DOORS AND WINDOWS	<input type="checkbox"/> FINISHES
<input type="checkbox"/> SPECIALTIES	<input checked="" type="checkbox"/> EQUIPMENT	<input type="checkbox"/> FURNISHINGS	<input type="checkbox"/> SPECIAL CONSTRUCTION
<input type="checkbox"/> CONVEYING SYSTEMS	<input checked="" type="checkbox"/> MECHANICAL	<input type="checkbox"/> ELECTRICAL	<input type="checkbox"/> INSTRUMENTATION

PERSONNEL ON JOB: 9    TOTAL HOUR'S: 8

**MAJOR EQUIPMENT ON PROJECT**

<input type="checkbox"/> CRANES	<input type="checkbox"/> LOADERS	<input type="checkbox"/> BACKHOES (TRK)	<input type="checkbox"/> BACKHOES (TIRE)	<input type="checkbox"/> DOZERS
<input type="checkbox"/> WELDERS	<input checked="" type="checkbox"/> PUMPS	<input checked="" type="checkbox"/> COMPRESSORS	<input checked="" type="checkbox"/> TRUCK	<input checked="" type="checkbox"/> LIFTS

TESTING DONE TODAY: None

MATERIALS RECEIVED TODAY: None

DIFFICULTIES ON JOB: None

DIFFICIENCIES: None

DISPUTES: None

DESCRIPTION OF WORK ACCOMPLISHED:  
IPR has moved to repair next section from 25+00 to 28+95. They are grouting the top half either by buttering in concrete or spraying.

CONTRACTOR COMMENTS: None

VISITORS: \_\_\_\_\_

PROJECT SUPERINTENDENT: Chuck Slack  
RESIDENT PROJECT REPRESENTATIVE: Juan Vela

**FIELD PROJECT REPORT**

REPORT: 99	<input type="checkbox"/> MON	<input type="checkbox"/> TUE	<input checked="" type="checkbox"/> WED	<input type="checkbox"/> TH	<input type="checkbox"/> FRI	DATE: 07-09-14
------------	------------------------------	------------------------------	---	-----------------------------	------------------------------	----------------

**Project Information**

<b>PROJECT</b>	RADO Storm Sewer Rehab	<b>DAYS USED IN CONTRACT</b>
<b>OWNER:</b>	Hidalgo County Drainage District	<b>MHI JOB #</b> 07129.16
<b>CONTRACTOR:</b>	Inland Pipe Rehab South Central / REIM	

<b>WEATHER</b>	<b>TEMPERATURES:</b> 94	<b>CONDITION</b>
<input type="checkbox"/> CLEAR	<input type="checkbox"/> CLOUDY	<input type="checkbox"/> DRY
<input type="checkbox"/> PARTLY CLOUDY	<input checked="" type="checkbox"/> RAIN	<input type="checkbox"/> DAMP
		<input type="checkbox"/> MUDDY
		<input type="checkbox"/> OVERCAST

**CLASSIFICATION OF WORKMEN ON THE PROJECT**

<input checked="" type="checkbox"/> SITEWORK	<input type="checkbox"/> CONCRETE	<input type="checkbox"/> MASONRY	<input type="checkbox"/> REBAR
<input type="checkbox"/> WOOD AND PLASTICS	<input type="checkbox"/> THERMAL MOISTURE PRO	<input type="checkbox"/> DOORS AND WINDOWS	<input type="checkbox"/> FINISHES
<input type="checkbox"/> SPECIALTIES	<input checked="" type="checkbox"/> EQUIPMENT	<input type="checkbox"/> FURNISHINGS	<input type="checkbox"/> SPECIAL CONSTRUCTION
<input type="checkbox"/> CONVEYING SYSTEMS	<input checked="" type="checkbox"/> MECHANICAL	<input type="checkbox"/> ELECTRICAL	<input type="checkbox"/> INSTRUMENTATION
<b>PERSONNEL ON JOB:</b> 9		<b>TOTAL HOUR'S:</b> 8	

**MAJOR EQUIPMENT ON PROJECT**

<input type="checkbox"/> CRANES	<input type="checkbox"/> LOADERS	<input type="checkbox"/> BACKHOES (TRK)	<input type="checkbox"/> BACKHOES (TIRE)	<input type="checkbox"/> DOZERS
<input type="checkbox"/> WELDERS	<input checked="" type="checkbox"/> PUMPS	<input checked="" type="checkbox"/> COMPRESSORS	<input checked="" type="checkbox"/> TRUCK	<input checked="" type="checkbox"/> LIFTS

TESTING DONE TODAY: None

MATERIALS RECEIVED TODAY: None

DIFFICULTIES ON JOB: None

DIFFICIENCIES: None

DISPUTES: None

**DESCRIPTION OF WORK ACCOMPLISHED:**  
 IPR is continuing repair work having started working on another 300 feet north of station 28+95. Although they are still working on the bottom half from station 25+00 inserting ports for filling areas at the joints of pipes.

CONTRACTOR COMMENTS: None

VISITORS:

**PROJECT SUPERINTENDENT:** Chuck Slack  
**RESIDENT PROJECT REPRESENTATIVE:** Juan Vela

**FIELD PROJECT REPORT**

REPORT: 100     MON     TUE     WED     TH     FRI    DATE: 07-11-14

**Project Information**

PROJECT: *RADO Storm Sewer Rehab*      DAYS USED IN CONTRACT: \_\_\_\_\_

OWNER: *Hidalgo County Drainage District*      MHI JOB # **07129.16**

CONTRACTOR: *Inland Pipe Rehab South Central / REIM*

WEATHER      TEMPERATURES: 94      CONDITION

<input type="checkbox"/> CLEAR	<input type="checkbox"/> CLOUDY	<input checked="" type="checkbox"/> PARTLY CLOUDY	<input type="checkbox"/> RAIN	<input type="checkbox"/> DRY	<input type="checkbox"/> DAMP	<input type="checkbox"/> MUDDY	<input type="checkbox"/> OVERCAST
--------------------------------	---------------------------------	---	-------------------------------	------------------------------	-------------------------------	--------------------------------	-----------------------------------

**CLASSIFICATION OF WORKMEN ON THE PROJECT**

<input checked="" type="checkbox"/> SITEWORK	<input type="checkbox"/> CONCRETE	<input type="checkbox"/> MASONRY	<input type="checkbox"/> REBAR
<input type="checkbox"/> WOOD AND PLASTICS	<input type="checkbox"/> THERMAL MOISTURE PRO	<input type="checkbox"/> DOORS AND WINDOWS	<input type="checkbox"/> FINISHES
<input type="checkbox"/> SPECIALTIES	<input checked="" type="checkbox"/> EQUIPMENT	<input type="checkbox"/> FURNISHINGS	<input type="checkbox"/> SPECIAL CONSTRUCTION
<input type="checkbox"/> CONVEYING SYSTEMS	<input checked="" type="checkbox"/> MECHANICAL	<input type="checkbox"/> ELECTRICAL	<input type="checkbox"/> INSTRUMENTATION

PERSONNEL ON JOB: 9      TOTAL HOUR'S: 8

**MAJOR EQUIPMENT ON PROJECT**

<input type="checkbox"/> CRANES	<input type="checkbox"/> LOADERS	<input type="checkbox"/> BACKHOES (TRK)	<input type="checkbox"/> BACKHOES (TIRE)	<input type="checkbox"/> DOZERS
<input type="checkbox"/> WELDERS	<input checked="" type="checkbox"/> PUMPS	<input checked="" type="checkbox"/> COMPRESSORS	<input checked="" type="checkbox"/> TRUCK	<input checked="" type="checkbox"/> LIFTS

TESTING DONE TODAY: None

MATERIALS RECEIVED TODAY: None

DIFFICULTIES ON JOB: None

DIFFICIENCIES: None

DISPUTES: None

**DESCRIPTION OF WORK ACCOMPLISHED:**

IPR has sealed section 25+00 to station 28+95 and is now preparing to run sled for final passes.

They also are continuing the work of grouting and sealing the top half of next 300 foot section.

IPR is working on storm line connections.

CONTRACTOR COMMENTS: None

VISITORS: \_\_\_\_\_

PROJECT SUPERINTENDENT: Chuck Slack  
RESIDENT PROJECT REPRESENTATIVE: Juan Vela

**FIELD PROJECT REPORT**

REPORT: 101     MON     TUE     WED     TH     FRI    DATE: 07-14-14

**Project Information**

PROJECT	RADO Storm Sewer Rehab	DAYS USED IN CONTRACT

OWNER: Hidalgo County Drainage District    MHI JOB # 07129.16

CONTRACTOR: Inland Pipe Rehab South Central / REIM

WEATHER	TEMPERATURES: 100	CONDITION
<input type="checkbox"/> CLEAR <input type="checkbox"/> CLOUDY <input checked="" type="checkbox"/> PARTLY CLOUDY	<input type="checkbox"/> RAIN <input type="checkbox"/> DRY	<input type="checkbox"/> DAMP <input type="checkbox"/> MUDDY <input type="checkbox"/> OVERCAST

**CLASSIFICATION OF WORKMEN ON THE PROJECT**

<input checked="" type="checkbox"/> SITEWORK	<input type="checkbox"/> CONCRETE	<input type="checkbox"/> MASONRY	<input type="checkbox"/> REBAR
<input type="checkbox"/> WOOD AND PLASTICS	<input type="checkbox"/> THERMAL MOISTURE PRO	<input type="checkbox"/> DOORS AND WINDOWS	<input type="checkbox"/> FINISHES
<input type="checkbox"/> SPECIALTIES	<input checked="" type="checkbox"/> EQUIPMENT	<input type="checkbox"/> FURNISHINGS	<input type="checkbox"/> SPECIAL CONSTRUCTION
<input type="checkbox"/> CONVYING SYSTEMS	<input checked="" type="checkbox"/> MECHANICAL	<input type="checkbox"/> ELECTRICAL	<input type="checkbox"/> INSTRUMENTION

PERSONNEL ON JOB: 9    TOTAL HOUR'S: 8

**MAJOR EQUIPMENT ON PROJECT**

<input type="checkbox"/> CRANES	<input type="checkbox"/> LOADERS	<input type="checkbox"/> BACKHOES (TRK)	<input type="checkbox"/> BACKHOES (TIRE)	<input type="checkbox"/> DOZERS
<input type="checkbox"/> WELDERS	<input checked="" type="checkbox"/> PUMPS	<input checked="" type="checkbox"/> COMPRESSORS	<input checked="" type="checkbox"/> TRUCK	<input checked="" type="checkbox"/> LIFTS

TESTING DONE TODAY: None

MATERIALS RECEIVED TODAY: None

DIFFICULTIES ON JOB: None

DIFFICIENCIES: None

DISPUTES: None

DESCRIPTION OF WORK ACCOMPLISHED:  
IPR continues placing ports on bottom half of next pipe section at joints for grout injection up to Station 31+95. They have now started dewatering next 400 foot section for repair.

CONTRACTOR COMMENTS: None

VISITORS:

PROJECT SUPERINTENDENT: Chuck Slack  
RESIDENT PROJECT REPRESENTATIVE: Juan Vela

**FIELD PROJECT REPORT**

REPORT: 102     MON     TUE     WED     TH     FRI    DATE: 07-22-14

**Project Information**

<b>PROJECT</b>	<i>RADO Storm Sewer Rehab</i>	<b>DAYS USED IN CONTRACT</b>

<b>OWNER:</b>	<i>Hidalgo County Drainage District</i>	<b>MHI JOB # 07129.16</b>
---------------	---	---------------------------

<b>CONTRACTOR:</b>	<i>Inland Pipe Rehab South Central / REIM</i>	
--------------------	---	--

<b>WEATHER</b>	<b>TEMPERATURES: 102</b>	<b>CONDITION</b>
<input type="checkbox"/> CLEAR <input type="checkbox"/> CLOUDY <input type="checkbox"/> PARTLY CLOUDY	<input type="checkbox"/> RAIN <input type="checkbox"/> DRY	<input type="checkbox"/> DAMP <input type="checkbox"/> MUDDY <input checked="" type="checkbox"/> OVERCAST

**CLASSIFICATION OF WORKMEN ON THE PROJECT**

<input checked="" type="checkbox"/> SITEWORK	<input type="checkbox"/> CONCRETE	<input type="checkbox"/> MASONRY	<input type="checkbox"/> REBAR
<input type="checkbox"/> WOOD AND PLASTICS	<input type="checkbox"/> THERMAL MOISTURE PRO	<input type="checkbox"/> DOORS AND WINDOWS	<input type="checkbox"/> FINISHES
<input type="checkbox"/> SPECIALTIES	<input checked="" type="checkbox"/> EQUIPMENT	<input type="checkbox"/> FURNISHINGS	<input type="checkbox"/> SPECIAL CONSTRUCTION
<input type="checkbox"/> CONVEYING SYSTEMS	<input checked="" type="checkbox"/> MECHANICAL	<input type="checkbox"/> ELECTRICAL	<input type="checkbox"/> INSTRUMENTATION

PERSONNEL ON JOB: 9	TOTAL HOUR'S: 8
---------------------	-----------------

**MAJOR EQUIPMENT ON PROJECT**

<input type="checkbox"/> CRANES	<input type="checkbox"/> LOADERS	<input type="checkbox"/> BACKHOES (TRK)	<input type="checkbox"/> BACKHOES (TIRE)	<input type="checkbox"/> DOZERS
<input type="checkbox"/> WELDERS	<input checked="" type="checkbox"/> PUMPS	<input checked="" type="checkbox"/> COMPRESSORS	<input checked="" type="checkbox"/> TRUCK	<input checked="" type="checkbox"/> LIFTS

TESTING DONE TODAY: None

MATERIALS RECEIVED TODAY: None

DIFFICULTIES ON JOB: None

DIFFICIENCIES: None

DISPUTES: None

DESCRIPTION OF WORK ACCOMPLISHED:  
IPR continues with the grout injection at the joints and bottom of pipe where water is entering. station 31+00

CONTRACTOR COMMENTS: None

VISITORS: \_\_\_\_\_

PROJECT SUPERINTENDENT: Chuck Slack  
RESIDENT PROJECT REPRESENTATIVE: Juan Vela



**FIELD PROJECT REPORT**

REPORT: 104     MON     TUE     WED     TH     FRI    DATE: 07-29-14

**Project Information**

PROJECT: *RADO Storm Sewer Rehab*      DAYS USED IN CONTRACT: \_\_\_\_\_

OWNER: *Hidalgo County Drainage District*      MHI JOB # 07129.16

CONTRACTOR: *Inland Pipe Rehab South Central / REIM*

WEATHER      TEMPERATURES: 102      CONDITION

CLEAR     CLOUDY     PARTLY CLOUDY     RAIN     DRY     DAMP     MUDDY     OVERCAST

**CLASSIFICATION OF WORKMEN ON THE PROJECT**

<input checked="" type="checkbox"/> SITEWORK	<input type="checkbox"/> CONCRETE	<input type="checkbox"/> MASONRY	<input type="checkbox"/> REBAR
<input type="checkbox"/> WOOD AND PLASTICS	<input type="checkbox"/> THERMAL MOISTURE PRO	<input type="checkbox"/> DOORS AND WINDOWS	<input type="checkbox"/> FINISHES
<input type="checkbox"/> SPECIALTIES	<input checked="" type="checkbox"/> EQUIPMENT	<input type="checkbox"/> FURNISHINGS	<input type="checkbox"/> SPECIAL CONSTRUCTION
<input type="checkbox"/> CONVEYING SYSTEMS	<input checked="" type="checkbox"/> MECHANICAL	<input type="checkbox"/> ELECTRICAL	<input type="checkbox"/> INSTRUMENTATION

PERSONNEL ON JOB: 9      TOTAL HOUR'S: 8

**MAJOR EQUIPMENT ON PROJECT**

<input type="checkbox"/> CRANES	<input type="checkbox"/> LOADERS	<input type="checkbox"/> BACKHOES (TRK)	<input type="checkbox"/> BACKHOES (TIRE)	<input type="checkbox"/> DOZERS
<input type="checkbox"/> WELDERS	<input checked="" type="checkbox"/> PUMPS	<input checked="" type="checkbox"/> COMPRESSORS	<input checked="" type="checkbox"/> TRUCK	<input checked="" type="checkbox"/> LIFTS

TESTING DONE TODAY: None

MATERIALS RECEIVED TODAY: None

DIFFICULTIES ON JOB: None

DIFFICIENCIES: None

DISPUTES: None

DESCRIPTION OF WORK ACCOMPLISHED:  
IPR is working on sealing top half of remaining section of pipe. There is a lot more infiltration in this last section of pipe given to the failure within the pipe.

CONTRACTOR COMMENTS: None

VISITORS: \_\_\_\_\_

PROJECT SUPERINTENDENT: Chuck Slack  
RESIDENT PROJECT REPRESENTATIVE: Juan Vela

**FIELD PROJECT REPORT**

REPORT: 105     MON     TUE     WED     TH     FRI    DATE: 07-31-14

**Project Information**

<b>PROJECT</b>	<i>RADO Storm Sewer Rehab</i>	<b>DAYS USED IN CONTRACT</b>

<b>OWNER:</b>	<i>Hidalgo County Drainage District</i>	<b>MHI JOB # 07129.16</b>
---------------	---	---------------------------

<b>CONTRACTOR:</b>	<i>Inland Pipe Rehab South Central / REIM</i>	
--------------------	---	--

<b>WEATHER</b>	<b>TEMPERATURES: 103</b>	<b>CONDITION</b>
<input checked="" type="checkbox"/> CLEAR <input type="checkbox"/> CLOUDY <input type="checkbox"/> PARTLY CLOUDY <input type="checkbox"/> RAIN <input type="checkbox"/> DRY <input type="checkbox"/> DAMP <input type="checkbox"/> MUDDY <input type="checkbox"/> OVERCAST		

**CLASSIFICATION OF WORKMEN ON THE PROJECT**

<input checked="" type="checkbox"/> SITEWORK	<input type="checkbox"/> CONCRETE	<input type="checkbox"/> MASONRY	<input type="checkbox"/> REBAR
<input type="checkbox"/> WOOD AND PLASTICS	<input type="checkbox"/> THERMAL MOISTURE PRO	<input type="checkbox"/> DOORS AND WINDOWS	<input type="checkbox"/> FINISHES
<input type="checkbox"/> SPECIALTIES	<input checked="" type="checkbox"/> EQUIPMENT	<input type="checkbox"/> FURNISHINGS	<input type="checkbox"/> SPECIAL CONSTRUCTION
<input type="checkbox"/> CONVEYING SYSTEMS	<input checked="" type="checkbox"/> MECHANICAL	<input type="checkbox"/> ELECTRICAL	<input type="checkbox"/> INSTRUMENTION

PERSONNEL ON JOB: 9	TOTAL HOUR'S: 8
---------------------	-----------------

**MAJOR EQUIPMENT ON PROJECT**

<input type="checkbox"/> CRANES	<input type="checkbox"/> LOADERS	<input type="checkbox"/> BACKHOES (TRK)	<input type="checkbox"/> BACKHOES (TIRE)	<input type="checkbox"/> DOZERS
<input type="checkbox"/> WELDERS	<input checked="" type="checkbox"/> PUMPS	<input checked="" type="checkbox"/> COMPRESSORS	<input checked="" type="checkbox"/> TRUCK	<input checked="" type="checkbox"/> LIFTS

TESTING DONE TODAY: None

MATERIALS RECEIVED TODAY: None

DIFFICULTIES ON JOB: None

DIFFICIENCIES: None

DISPUTES: None

DESCRIPTION OF WORK ACCOMPLISHED:

IPR is working on placement of ports for grout injection at station 33+00.

CONTRACTOR COMMENTS: None

VISITORS: \_\_\_\_\_

PROJECT SUPERINTENDENT: Chuck Slack  
RESIDENT PROJECT REPRESENTATIVE: Juan Vela



TBPE Firm # F-1435  
TBPLS # 10096900

# MELDEN & HUNT INC.

CONSULTANTS • ENGINEERS • SURVEYORS  
FRED L. KURTH • ALLAN F. BOOE • KELLEY A. HELLER-VELA • ROBERT TAMEZ

## RADO Drain Project Engineering Report

JULY, 2014

- 1) IPR has repaired a 700 foot section of this pipe from station 25+00 to station 32+00.
- 2) They have started on the final 400 foot section of the east pipe.



---

Fred L. Kurth, P.E. #54151

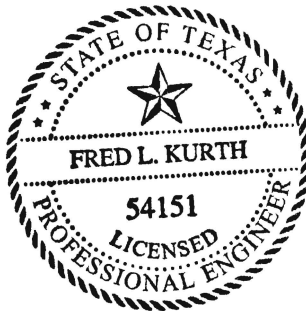

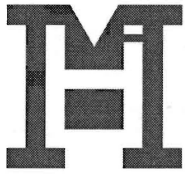

# MELDEN & HUNT INC.

CONSULTANTS ENGINEERS SURVEYORS

TBPE FIRM# F-1435

115 West McIntyre  
Edinburg, TX 78541  
(956) 381-0981  
(956) 381-1839 fax  
[www.meldenandhunt.com](http://www.meldenandhunt.com)

227 N. FM 3167  
Rio Grande City, TX 78582  
(956) 487-8256  
(956) 488-8591 fax

Date: August 19, 2014

## Transmittal

To:	Hidalgo County Drainage District
Attention:	Mr. Godfrey Garza
From:	Laura C. Garcia
Job Title:	RADO Drain Project
Job No.:	07129.01

### The following is being transmitted:

- Plans  
 Construction Drawings  
 Documents  
 CD/Diskette  
 Legal Descriptions  
 Letter  
 Original Plat  
 Copies  
 Fee  
 Other:

### Transmitted as Follows:

- For your use  
 As Requested  
 Review/Comment  
 Approval  
 Signature  
 FYI

No. of Copies	Description
1	July Invoice and Inspection Reports; July Engineering Report

Remarks: Please review for processing.

**RECEIVED**  
HIDALGO COUNTY  
DRAINAGE DISTRICT #1

AUG 19 2014

11:45 AM PM

BY: Rosa Arce

Transmitted By: Laura C. Garcia, Accounting Dept.

Received By: *Myshawn Landon*

Date: 8/19/14 Time: 11:14 AM

# HIDALGO COUNTY DRAINAGE DISTRICT NUMBER ONE

502 NORTH DOOLITTLE

EDINBURG, TEXAS 78542

(956) 292-7080

FAX (956) 292-7089



GODFREY GARZA, JR.  
MANAGER

## INVOICE PROCESSING CHECKLIST

Date Received: 8-27-14 PO# 023575

Engineer/Firm Name: TECSI INC.

Project Name/Number: East Lateral Drain July

Invoice No: # 20142033

Logged in and Scanned 309 8/27 By: Rosa Arce Forwarded to: Joy Guera

Engineer	Name	Date	Comment
Scope of work reviewed			

Accounting	Name	Date	Comment
Encumbrance			
Purchase Order Attached			
Audit			
Final Approval for Agenda			

	Name	Date	Comment
Placed on Agenda			

Additional Comments: \_\_\_\_\_

\_\_\_\_\_

\_\_\_\_\_

\_\_\_\_\_



**TEDSI INFRASTRUCTURE GROUP**

**TEDSI**

*Consulting Engineers*  
1201 E. Expressway 83 ♦ Mission, Texas 78572  
(956) 424-7898

Letter of  
Transmittal

TO:  
Ms. Claudette Guerrero  
Hidalgo County Drainage District No. 1  
902 N. Doolittle Road  
Edinburg, Texas 78542

DATE:  
August 25, 2014

REF.:  
East Lateral Drain July Invoice

TEDSI PROJECT NO.:  
2013-1128-09

TRANSMITTED:

- |  |   |  |
|--|---|--|
| <input checked="" type="checkbox"/> For Your Use | <input type="checkbox"/> Please comment | <input type="checkbox"/> Approved as Noted |
| <input type="checkbox"/> As Requested            | <input type="checkbox"/> Reply ASAP     | <input type="checkbox"/> As Noted Below    |

VIA:

- |                                  |  |                                     |
|----------------------------------|--|-------------------------------------|
| <input type="checkbox"/> US Mail | <input type="checkbox"/> Courier                       | <input type="checkbox"/> Hand Carry |
| <input type="checkbox"/> E-Mail  | <input checked="" type="checkbox"/> LoneStar Overnight | <input type="checkbox"/> FedEx      |

COPIES	DESCRIPTION
1	Invoice No. 20142033 for Project No. 2013-1128-09
1	Project Progress Report
1	CD PDF Files

REMARKS:

Thank you,

**RECEIVED**  
HIDALGO COUNTY  
DRAINAGE DISTRICT #1

AUG 27 2014

1:20 AM (P)

BY: Rosa Arce

Signed: *for: Clay*  
Mark W. Lupher, P.E., RPLS



**TEDSI**  
TBPE F-1640

**TEDSI INFRASTRUCTURE GROUP**

*Consulting Engineers*  
1201 East Expressway 83 ♦ Mission, Texas 78572  
Tel: (956) 424-7898  
Fax: (956) 424-7022

August 21, 2014

Project No: 2013-1128-09

Invoice No: 20142033

Ms. Claudette Guerrero  
Hidalgo County Drainage District No. 1  
902 North Doolittle Road  
Edinburg, TX 78542

**RECEIVED**  
HIDALGO COUNTY  
DRAINAGE DISTRICT #1

AUG 27 2014

1:20 AM PM

BY: Rosa One

Project 2013-1128-09 GLO-Review East Lateral Drain  
Account No. 13-132-433-039-43340  
P. O. No. 623575  
Precinct One 2012 Bond Referendum  
Work Authorization No. 9

**Professional Services from July 01, 2014 to July 31, 2014**

Billing Phase	Fee	Percent Complete	Earned	Previous Fee Billing	Current Fee Billing
Phase 100 GMC Services					
General Management Consultant Services	29,069.25	24.60	7,151.04	7,151.04	0.00
Total Fee	29,069.25		7,151.04	7,151.04	0.00
<b>Total Fee</b>					<b>0.00</b>
<b>Total this Phase</b>					<b>0.00</b>

Phase	200	ROW Services			
<b>Consultants</b>					
Reimbursable Consultants Expense					
7/31/2014		RGV Right-Of-Way Services, LLC		6,944.99	
		Invoice No. 10010			
		<b>Total Consultants</b>		<b>6,944.99</b>	<b>6,944.99</b>
<b>Total this Phase</b>					<b>\$6,944.99</b>

Billing Summary	Current	Prior	To-Date
Total Billings	6,944.99	41,753.25	48,698.24
Total Fee			94,069.25
Remaining Fee			45,371.01

**Total this Invoice \$6,944.99**

**Outstanding Invoices**

Number	Date	Balance
20141992	7/16/2014	5,537.19
<b>Total</b>		<b>5,537.19</b>

**Total Now Due                    \$12,482.18**

**PLEASE REMIT PAYMENT TO:**  
TEDSI Infrastructure Group, Inc.  
738 Highway 6 South, Suite 430  
Houston, Texas 77079

Authorized By:  Date: 8.21.14  
Mark W. Luper, P.E., RPLS  
Executive Vice President



2013-1128-09

**RGV Right-of-Way Services, LLC**

P.O. Box 720431  
McAllen, TX 78504

Invoice submitted to:  
TEDSI Infrastructure Group  
c/o Mr. Mark Luper  
1201 E. Expressway 83  
Mission, TX 78572

July 31, 2014

In Reference To: East Lateral Project  
Invoice #10010

<b>TEDSI INFRASTRUCTURE GROUP</b>		
Project No. <u>2013-1128-09</u>	Phase No. <u>200</u>	
<input type="checkbox"/> Lump Sum	<input checked="" type="checkbox"/> Approved	<input type="checkbox"/> Hold
<input checked="" type="checkbox"/> Hourly	<input type="checkbox"/> Rejected	<input checked="" type="checkbox"/> Process
Sign <u>MLOL</u>	Date <u>8/2/14</u>	

Professional Services

	<u>Hrs/Rate</u>	<u>Amount</u>
6/30/2014 Preparation for Hidalgo County Commissioners meeting	1.50 250.00/hr	375.00
Attend Hidalgo County Commissioners meeting	3.50 250.00/hr	875.00
Telephone conference with Mr. Bill Pope regarding Parcel 1	0.20 250.00/hr	50.00
Telephone conference with Mr. Luis Cardenas regarding Parcel 21	0.20 250.00/hr	50.00
7/3/2014 Draft and prepare correspondence to Mr. Bill Pope regarding Parcel 1 counter offer	0.40 250.00/hr	100.00
Draft and prepare correspondence to Mr. Luis Cardenas regarding Parcel 21 counter offer	0.40 250.00/hr	100.00
7/7/2014 Received and reviewed correspondence regarding Parcel 18. Offer acceptance letter, Kansas State corporate records and W-9 form	0.50 250.00/hr	125.00
Draft and prepare email correspondence to Urban County regarding Parcel 18 offer acceptance	0.20 250.00/hr	50.00
Received and reviewed correspondence from Mr. Luis Cardenas regarding Parcel 34 contact information for sibling not represented by his office	0.30 250.00/hr	75.00
Telephone conference with Ms. Hilda Garza with Valley Land Title regarding file closing status	0.30 250.00/hr	75.00
Office visit to Dr. Mangoo-Karim Parcel 7 and 7A	0.70 250.00/hr	175.00

	<u>Hrs/Rate</u>	<u>Amount</u>
7/7/2014 Telephone call to George D'Hemecourt Parcels 42, 43 & 46	0.10 250.00/hr	25.00
7/8/2014 Received and reviewed correspondence from Mr. Luis Cardenas regarding Parcel 21 counter offer	0.30 250.00/hr	75.00
Draft and prepare correspondence to Mr. Luis Cardenas regarding Parcel 21 counter offer	0.40 250.00/hr	100.00
Received and reviewed email correspondence from J. Adams regarding status report	0.20 250.00/hr	50.00
7/9/2014 Draft and prepare new offer letters to all of Parcel 34 property owners	0.50 250.00/hr	125.00
7/10/2014 Received and reviewed email correspondence from J. Adams regarding Parcels 1, 18 and 21	0.20 250.00/hr	50.00
Telephone call to Bill Pope regarding Parcel 1	0.10 250.00/hr	25.00
Attempt home visit Hector Decanini Parcel 47	0.80 250.00/hr	200.00
7/11/2014 Draft and prepare email correspondence to J. Adams regarding Parcels 1, 18 and 21	0.10 250.00/hr	25.00
File Management; Status Updates; Administrative Tasks	2.30 250.00/hr	575.00
Attempt home visit Alejandro Trevino Parcel 29	1.00 250.00/hr	250.00
7/14/2014 Telephone call to Bill Pope regarding Parcel 1	0.10 250.00/hr	25.00
Office visit to Dr. Mangoo-Karim Parcel 7 and 7A	0.80 250.00/hr	200.00
7/15/2014 Preparation for Hidalgo County Commissioner meeting	1.10 250.00/hr	275.00
Attend Hidalgo County Commissioner meeting	2.10 250.00/hr	525.00
7/18/2014 File Management; Status Updates; Administrative Tasks	2.30 250.00/hr	575.00

	<u>Hrs/Rate</u>	<u>Amount</u>
7/24/2014 Received and reviewed email correspondence from J. Adams regarding status report	0.20 250.00/hr	50.00
Telephone conference with Mr. PR Avila regarding update	0.20 250.00/hr	50.00
Attempt home visit Alejandro Trevino Parcel 29	1.00 250.00/hr	250.00
7/25/2014 Received and reviewed correspondence from Mr. Luis Cardenas regarding Parcel 21 counter offer acceptance	0.30 250.00/hr	75.00
Draft and prepare email correspondence to Urban County regarding Parcel 21 offer acceptance	0.20 250.00/hr	50.00
File Management; Status Updates; Administrative Tasks	2.00 250.00/hr	500.00
7/29/2014 Preparation for Hidalgo County Commissioner meeting	0.70 250.00/hr	175.00
Attend Hidalgo County Commissioner meeting	1.10 250.00/hr	275.00
Draft and prepare package to Hilda Garza with Valley Land Title; Parcel 18 was approved and is ready for closing; hand delivered package	1.40 250.00/hr	350.00
<b>For professional services rendered</b>	<hr/> 27.70	<hr/> \$6,925.00
Additional Charges :		
7/9/2014 Postage for Parcel 34		19.99
<b>Total additional charges</b>		<hr/> \$19.99
<b>Total amount of this bill</b>		<hr/> \$6,944.99
<b>Previous balance</b>		<b>\$11,112.50</b>
Accounts receivable transactions		
7/8/2014 Payment - Thank You No. 49074		(\$6,912.50)
<b>Total payments and adjustments</b>		<hr/> (\$6,912.50)
Balance due		<hr/> <hr/> \$11,144.99



P.O. Box 720431  
McAllen, Texas 78504

956-630-9401 Office  
956-682-0566 Fax  
rgvrow@gmail.com

Date: July 3, 2014

VIA FACSIMILE (956) 428-2954

Mr. Bill Pope  
Adams & Graham, LLC  
134 E. Van Buren Ave., Suite 301  
Harlingen, Texas 78551

RE: Delta Area Connector/East Lateral  
Drainage Improvement Project  
Parcel # 1  
Property Owner: Dr. Ricardo Ochoa  
GLO # 12-406-000-6453/DRS 210068

Dear Mr. Pope:

Please allow this correspondence to serve as a follow up to your client's request for payment in the amount of \$59,927.00 concerning the Hidalgo County Drainage District right of way acquisition project referenced above. After conferring with the County regarding your client's offer, the County has authorized me to offer \$38,000.00 for the acquisition of the above-referenced property.

Please contact me at your earliest convenience regarding whether your client accepts this offer.

Your attention to this matter is greatly appreciated.

Respectfully,

A handwritten signature in black ink, appearing to read "D.G. Rios", is written over the typed name.

Daniel G. Rios, President  
RGV Right-of-Way Services, LLC



P.O. Box 720431  
McAllen, Texas 78504

956-630-9401 Office  
956-682-0566 Fax  
rgvrow@gmail.com

Date: July 3, 2014

VIA FACSIMILE 618-3361

Mr. Luis Cardenas  
Escobedo, Tippet & Cardenas  
3900 N. 10<sup>th</sup> St., Suite 950  
McAllen, Texas 78501

RE: Delta Area Connector/East Lateral  
Drainage Improvement Project  
GLO # 12-406-000-6453/DRS 210068  
Parcels: 21  
Your client/Parcel Owner: William and June Pracht

Dear Luis:

Please allow this correspondence to serve as a follow up to your client's request for payment in the amount of \$6,500.00 concerning the Hidalgo County Drainage District right of way acquisition project referenced above. After conferring with the County regarding your client's offer, the County has authorized me to offer \$4,000.00 for the acquisition of the above-referenced property.

Please contact me at your earliest convenience regarding whether your client accepts this offer.

Your attention to this matter is greatly appreciated.

Respectfully,

A handwritten signature in black ink that reads "D.G. Rios".

Daniel G. Rios, President  
RGV Right-of-Way Services, LLC



P.O. Box 720431  
McAllen, Texas 78504

956-630-9401 Office  
956-682-0566 Fax  
rgvrow@gmail.com

Date: July 8, 2014

VIA FACSIMILE 618-3361

Mr. Luis Cardenas  
Escobedo, Tippet & Cardenas  
3900 N. 10<sup>th</sup> St., Suite 950  
McAllen, Texas 78501

RE: Delta Area Connector/East Lateral  
Drainage Improvement Project  
GLO # 12-406-000-6453/DRS 210068  
Parcels: 21  
Your client/Parcel Owner: William and June Pracht

Dear Luis:

Thank you for your prompt response to my letter dated July 3, 2014. My client has authorized me to offer \$5,000.00 for final settlement of this matter. If your client is in agreement with resolving the matters as such, please indicate that to me at your earliest convenience. I hope to put this matter on the County Commissioner's agenda for next week.

Thank you for your attention to this matter.

Respectfully,

A handwritten signature in black ink, appearing to read "D.G. Rios", is written over the typed name.

Daniel G. Rios, President  
RGV Right-of-Way Services, LLC



P.O. Box 720431  
McAllen, Texas 78504

956-630-9401 Office  
956-682-0566 Fax  
rgvrow@gmail.com

Date: July 9, 2014

County: Hidalgo  
Federal Project No.: N/A  
Highway: Between Mile 2  
West & Mile 1 West Rd.

ROW GLO: 12-406-000-6453/DRS 210068  
Parcel: 34  
From: 0.25 South of Mile 13 North Road  
TO: 0.75 Miles North of Mile 19 North Road

**VIA FACSIMILE (956) 618-3357**

Mary Jane Malone, Rita Kay Jeter,  
Paul Lawrence Pracht, Patrick  
Ernest Pracht, Thomas Allen Pracht  
and Frances Louise Getzinger

c/o Mr. Luis Cardenas  
Escobedo Tippit & Cardenas, LLP  
3900 N. 10<sup>th</sup> St., Suite 950  
McAllen, TX 78501

**VIA OVERNIGHT DELIVERY**

Paula Jane Munoz  
1330 S. Bleckley  
Wichita, KS 67218

Dear Sir/Madam,

In acquiring property for the Drainage system of the County of Hidalgo (the "County") in conjunction with Disaster Recovery Entitlement Grant follows a definite procedure for appraising the land needed and for handling personal negotiations with each owner. As has been or will be explained by the County's negotiator, Daniel G. Rios, a portion of your property located to the rear of your land, as described in the enclosed property description, is to be acquired for the construction or improvements of the above-referenced Drainage project.

We believe at this stage of the purchase process it is mutually beneficial to confirm that, based on an appraisal, the Hidalgo County Commissioners' Court has authorized me to make an offer to you in the amount of \$69,657.00 for your property, which includes \$60,669.00 for the property to be purchased and \$8,988.00 for damages/improvements to your remaining property. This amount is the total amount of just compensation for all interests in the portion of your property to be acquired, as determined in accordance with State law, less oil, gas and sulphur, subject to clear title being conveyed to the County. In accordance with State law, it is the policy of the County to negotiate with the fee owner(s) of the real property with the understanding that you will, in turn, negotiate with any lessee or other party who may own any interest in the land or improvements, with the exception of public utility easements, which will be handled separately by the County.

This offer to purchase includes the contributory values of the improvement(s) listed below, which are considered to be part of the real property. Since the improvement(s) must be removed, it is the policy of



the County to permit owners who convey voluntarily to the County to thereafter retain the improvement(s), if they wish to do so. The retention values shown below are the estimated amounts the improvement(s) would bring if sold on public bids. If you wish to retain title to any of the following improvement(s) and remove it (them) from the right of way, the amount of the above offer must be reduced by the appropriate retention amount(s). This option to retain the improvement(s) does NOT apply should it become necessary for the County to acquire the real property by eminent domain.

<u>Improvement</u>	<u>Total Amount</u>
Agricultural Tile Drainage (\$1,500.00/acre x 5.992 Acres)	\$8,988.00

If you wish to accept the offer based upon this appraisal, please contact **Daniel G. Rios** as soon as possible, at (956) 630-9401, so that the process of issuing your payment may be started. **If you are not willing to accept this offer, you may submit a written request for administrative settlement/counteroffer, setting forth a counteroffer amount and the basis for such amount, provided such settlement request is received in writing within 30 days from the date of this letter.** Please note that your opportunity to submit an administrative settlement shall be forfeited if such a settlement request is not received by the Department within the 30 day time deadline.

In the event the condition of the property changes for any reason, the County shall have the right to withdraw or modify this offer.

After the date of payment of the purchase price, or the date of deposit in court of funds to satisfy the award of compensation as determined through eminent domain proceedings to acquire real property, you will be reimbursed for any fair and reasonable incidental expenses necessarily incurred in transferring title to the property for the use by the County of Hidalgo. Expenses eligible for reimbursement may include (1) recording fees, transfer taxes and similar expenses incidental to conveying the real property to the County and (2) penalty costs for prepayment of any preexisting recorded mortgage entered into in good faith encumbering the real property. Voluntary unnecessary expenses or expenses incurred in clearing questionable title will not be eligible for reimbursement. Eligible incidental expenses will be reimbursed upon submission of a claim supported by receipted bills or other evidence of actual expenses incurred. You may file a written request for review if you believe that the County failed to properly determine the eligibility for, or the amount of, incidental expenses to be reimbursed. There is no standard form on which to request a review of a claim; however, the claim must be filed with this office within six months after you are notified of the County's determination on any claim for reimbursement.

You may be entitled to additional payments and services under the County's Relocation Assistance Program. It is emphasized, however, that any benefits to which you may be entitled under this program will be handled entirely separate from and in addition to this transaction. You will receive a brochure entitled "Relocation Assistance" which will inform you of eligibility requirements, payments and services which are available.



You have the right to discuss with others any offer or agreement regarding the County's acquisition of the subject property, or you may (but are not required to) keep the offer or agreement confidential from others, subject to the provisions of Chapter 552, Government Code (the Public Records Act) as it may apply to the Department.

Attached is a copy of the Texas Department of Transportation brochure entitled "*Right of Way Purchase*" which we trust will give you a better understanding of the procedures followed by the County in purchasing property. We respectfully request the opportunity to meet with you or to otherwise discuss and answer any questions you may have regarding the details of the type of facility to be built, or concerning the County's offer or proposed purchase transaction. Also, please do not hesitate to contact me at the telephone number provided above regarding any questions you may have.

**Please see the enclosed copy of the Texas Landowner Bill of Rights.**

Finally, we enclosed copies of all appraisal reports relating to your property being acquired which were prepared in the ten (10) years preceding the date of this offer and produced or acquired by the Department, including the appraisal on which this offer is based.

Sincerely,

A handwritten signature in black ink, appearing to read "D.G. Rios".

Daniel G. Rios, President  
RGV Right-of-Way Services, LLC  
Right of Way Agent

**ENCLOSURES:**

Appraisal Report(s)  
Landowner Bill of Rights  
Brochure ("*Right of Way Purchase*")  
Relocation Assistance



OFFER RESPONSE FORM:

County: Hidalgo  
 Federal Project No.: N/A  
 Highway: Between Mile 2  
 West & Mile 1 West Rd.

ROW GLO: 12-406-000-6453/DRS 210068  
 Parcel: 34  
 From: 0.25 South of Mile 13 North Road  
 TO: 0.75 Miles North of Mile 19 North Road

Property Owners:

Mary Jane Malone, Rita Kay Jeter,  
 Paul Lawrence Pracht, Patrick  
 Ernest Pracht, Thomas Allen Pracht  
 and Frances Louise Getzinger

Paula Jane Munoz  
 1330 S. Bleckley  
 Wichita, KS 67218

c/o Mr. Luis Cardenas  
 Escobedo Tippit & Cardenas, LLP  
 3900 N. 10<sup>th</sup> St., Suite 950  
 McAllen, TX 78501

Offer Amount:	5.992 acres at \$10,125.00 per acre	\$60,669.00
	Damages/Improvements	\$8,988.00
	<b>TOTAL OFFER AMOUNT</b>	<b>\$69,657.00</b>

\_\_\_\_\_ I accept the offer and would like to begin the sale and closing process.

\_\_\_\_\_ I do not accept the offer; the amount requested is \_\_\_\_\_.

\_\_\_\_\_  
 Signature

\_\_\_\_\_  
 Signature

\_\_\_\_\_  
 Date

\_\_\_\_\_  
 Date

\*\*\*\*\*  
 \* YOUR RECEIPT \*  
 \* THANK YOU \*  
 \* \*  
 \*\*\*\*\*

07-10-2014 MC #:0000  
 DEPT 6 \*19.99  
 -----  
 SUBTTL \*19.99  
 -----  
 TOTAL \*19.99  
 CASH \*19.99

AM11-57 0029

HAVE A NICE DAY  
 PLEASE COME AGAIN

CUSTOMER USE ONLY

FROM: (PLEASE PRINT) PHONE 956-630-9401  
 RGV Right-of-Way Service, LLC  
 PO Box 720431  
 McAllen, TX 78504



PAYMENT BY ACCOUNT (if applicable)  
 USPS Corporate Acct. No. Federal Agency Acct. No. or Postal Service Acct. No.

DELIVERY OPTIONS (Customer Use Only)  
 SIGNATURE REQUIRED  
 Note: The mailer must check the "Signature Required" box if the mailer: 1) Requires the addressee's signature; OR 2) Purchases additional insurance; OR 3) Purchases COD service; OR 4) Purchases Return Receipt service, if the box is not checked, the Postal Service will leave the item in the addressee's mail receptacle or other secure location without attempting to obtain the addressee's signature on delivery.  
 Delivery Options  
 No Saturday Delivery (delivered next business day)  
 Sunday/Holiday Delivery Required (additional fee, where available)  
 \*Refer to USPS.com® or local Post Office™ for availability.

ORIGIN (POSTAL SERVICE USE ONLY)			
<input checked="" type="checkbox"/> 1-Day	<input type="checkbox"/> 2-Day	<input type="checkbox"/> Military	<input type="checkbox"/> DPO
PO ZIP Code 78504	Scheduled Delivery Date (MM/DD/YY) 7-11-14	Postage \$ 19.99	
Date Accepted (MM/DD/YY) 7-10-14	Scheduled Delivery Time <input checked="" type="checkbox"/> AM <input type="checkbox"/> PM	Insurance Fee \$	COD Fee \$
Time Accepted 12:00 PM	<input type="checkbox"/> Loss Guarantee Only	Return Receipt Fee \$	
<input checked="" type="checkbox"/> Flat Rate	<input type="checkbox"/> Live Shipment	Total Postage & Fees \$ 19.99	
Weight (lb. oz.) 15 00	<input type="checkbox"/> Sunday/Holiday Premium	Acceptance Employee Initials EK	

TO: (PLEASE PRINT) PHONE ( )  
 Paula Jane Munoz  
 1330 S. Bleckley  
 Wichita, KS  
 ZIP + 4® (U.S. ADDRESSES ONLY)  
 67218

DELIVERY (POSTAL SERVICE USE ONLY)		
Delivery Attempt (MM/DD/YY)	Time <input type="checkbox"/> AM <input type="checkbox"/> PM	Employee Signature
Delivery Attempt (MM/DD/YY)	Time <input type="checkbox"/> AM <input type="checkbox"/> PM	Employee Signature

■ For pickup or USPS Tracking™, visit USPS.com or call 800-222-1811.  
 ■ \$100.00 Insurance Included.





P.O. Box 720431  
McAllen, Texas 78504

956-630-9401 Office  
956-682-0566 Fax  
rgvrow@gmail.com

Date: July 29, 2014

VIA HAND DELIVERY

Ms. Hilda Garza  
Valley Land Title Co.  
520 E. Nolana, Suite 130  
McAllen, Texas 78504

RE: Delta Area Connector/East Lateral  
Drainage Improvement Project  
GLO # 12-406-000-6453/DRS 210068  
Parcel: 18

Dear Hilda:

With regard to the above-referenced matter, the Hidalgo County Commissioners Court along with Hidalgo County Urban County Program has formally approved the following parcels to begin the closing process. Enclosed herein please find a copy of the following on each of the approved tracts:

Parcel 18 – GF 132420 JECKL INVESTMENT COMPANY LLC

1. Acceptance Letter;
2. Signed W-9 Form for JECKL Investment Company, LLC;
3. Articles of Organization for JECKL Investment Company, LLC;
4. Warranty Deed dated September 3, 2013 recorded under Document No. 2452582 in the Hidalgo County Records;
5. Appraisal;
6. Survey; and
7. Minutes from Hidalgo County Commissioners Court approving the acquisition.

Please proceed to begin the closing proceedings on the above-referenced parcel.

Should you have any questions, or need any further information, please do not hesitate to contact me at your earliest convenience.

Your prompt attention to this matter is greatly appreciated.

Respectfully,

A handwritten signature in dark ink, appearing to read "D.G. Rios", is written over the typed name.

Daniel G. Rios, President  
RGV Right-of-Way Services, LLC

RECEIVED BY:

---

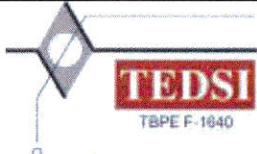
 <b>TEDSI INFRASTRUCTURE GROUP</b> <i>Consulting Engineers</i>	<h1>Project Progress Report</h1>	
<b>TO:</b> Hidalgo County Drainage District No. 1	<b>DATE:</b> August 25, 2014	
<b>FROM:</b> Mr. Mark Lupher, P.E., Project Manager	<b>TEDSI PROJECT NO.:</b> 2013-1128-09	
<b>REFERENCE:</b> East Lateral R.O.W. Acquisition		
Progress Report for Invoice No. 20142033, July 01 to July 31, 2014		

- Report by Week for Jason Adams
  - Week ending 07-04-2014
    - Coordinated with RGV Right of Way and Hidalgo County Precinct #1 regarding latest R.O.W. acquisition information.
    - Prepared and emailed weekly status update.
  - Week ending 07-11-2014
    - Coordinated with RGV Right of Way and Hidalgo County Precinct #1 regarding latest R.O.W. acquisition information.
    - Prepared and emailed weekly status update.
  - Week ending 07-18-2014
    - Coordinated with RGV Right of Way and Hidalgo County Precinct #1 regarding latest R.O.W. acquisition information.
    - Prepared and emailed weekly status update.
  - Week ending 07-25-2014
    - Coordinated with RGV Right of Way and Hidalgo County Precinct #1 regarding latest R.O.W. acquisition information.
    - Prepared and emailed weekly status update.
  - Week ending 08-01-2014
    - Coordinated with RGV Right of Way and Hidalgo County Precinct #1 regarding latest R.O.W. acquisition information.
    - Prepared and emailed weekly status update.
  - **SEE ATTACHED STATUS REPORTS FOR MORE DETAILED INFORMATION.**

# HIDALGO COUNTY DRAINAGE DISTRICT NUMBER ONE

302 NORTH DOOLITTLE

EDINBURG, TEXAS 78542

(956) 292-7080

FAX (956) 292-7089

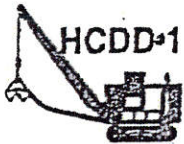

GODFREY GARZA, JR.  
MANAGER

## INVOICE PROCESSING CHECKLIST

Data Received: 8-27-14 PO# 623574

Engineer/Firm Name: TESI Inc.

Project Name/Number: Adam Black Colonia July

Invoice No: # 20142034

Logged in and Scanned: 313 8/27 By: Rosa Orce Forwarded to: Joey Garza

Engineer	Name	Date	Comment
Scope of work reviewed			

Accounting	Name	Date	Comment
Encumbrance			
Purchase Order Attached			
Audit			
Final Approval for Agenda			

	Name	Date	Comment
Placed on Agenda			

Additional Comments: \_\_\_\_\_

\_\_\_\_\_

\_\_\_\_\_

\_\_\_\_\_



# TEDSI INFRASTRUCTURE GROUP

**TEDSI**

*Consulting Engineers*  
1201 E. Expressway 83 ♦ Mission, Texas 78572  
(956) 424-7898

## Letter of Transmittal

TO:

Ms. Claudette Guerrero  
Hidalgo County Drainage District No. 1  
902 N. Doolittle Road  
Edinburg, Texas 78542

DATE:

August 25, 2014

REF.:

Adam Black Colonia July Invoice

TEDSI PROJECT NO.:

2013-1128-10

TRANSMITTED:

<input checked="" type="checkbox"/> For Your Use	<input type="checkbox"/> Please comment	<input type="checkbox"/> Approved as Noted
<input type="checkbox"/> As Requested	<input type="checkbox"/> Reply ASAP	<input type="checkbox"/> As Noted Below

VIA:

<input type="checkbox"/> US Mail	<input type="checkbox"/> Courier	<input type="checkbox"/> Hand Carry
<input type="checkbox"/> E-Mail	<input checked="" type="checkbox"/> LoneStar Overnight	<input type="checkbox"/> FedEx

COPIES

DESCRIPTION

1	Invoice No. 20142034 for Project No. 2013-1128-10
1	Adams Black Exhibit
1	Project Progress Report

REMARKS:

**RECEIVED**  
HIDALGO COUNTY  
DRAINAGE DISTRICT #1

Thank you,

AUG 27 2014

1:20 AM/PM

BY: Rosa Arce

Signed: \_\_\_\_\_

*for: Clay*

Mark W. Lupher, P.E., RPLS

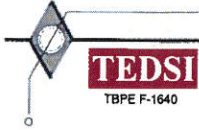

**TEDSI INFRASTRUCTURE GROUP**

*Consulting Engineers*

1201 East Expressway 83 + Mission, Texas 78572

Tel: (956) 424-7898

Fax: (956) 424-7022

August 21, 2014

Project No: 2013-1128-10

Invoice No: 20142034

Ms. Claudette Guerrero  
 Hidalgo County Drainage District No. 1  
 902 North Doolittle Road  
 Edinburg, TX 78542

**RECEIVED**  
 HIDALGO COUNTY  
 DRAINAGE DISTRICT #1

AUG 27 2014

1:20 AM/PM

BY: Rosa Arce

Project 2013-1128-10 Adams Black Colonia

Account No. 13-133-433-365-010-002-43340

P. O. No. 623574

Precinct One 2012 Bond Referendum

**Professional Services from July 01, 2014 to July 31, 2014**

Billing Phase	Fee	Percent Complete	Earned	Previous Fee Billing	Current Fee Billing	
Phase 100 General Management Consultant						
General Management Consultant Services	18,938.15	20.85	3,948.60	3,200.55	748.05	
Total Fee	18,938.15		3,948.60	3,200.55	748.05	
		<b>Total Fee</b>				<b>748.05</b>
				<b>Total this Phase</b>		<b>\$748.05</b>

Phase	Consultants	Fee			
400	ROW Acquisition				
	Reimbursable Consultants Expense				
	7/31/2014 RGV Right-Of-Way Services, LLC				250.00
	Invoice No. 10011				
	<b>Total Consultants</b>				<b>250.00</b>
				<b>Total this Phase</b>	<b>\$250.00</b>

Billing Summary	Current	Prior	To-Date
Total Billings	998.05	8,583.02	9,581.07
Total Fee			63,503.65
Remaining Fee			53,922.58
			<b>Total this Invoice</b>
			<b>\$998.05</b>

**Outstanding Invoices**

Number	Date	Balance		
20141993	7/16/2014	4,819.23		
<b>Total</b>		<b>4,819.23</b>	<b>Total Now Due</b>	<b>\$5,817.28</b>

**PLEASE REMIT PAYMENT TO:**  
TEDSI Infrastructure Group, Inc.  
738 Highway 6 South, Suite 430  
Houston, Texas 77079

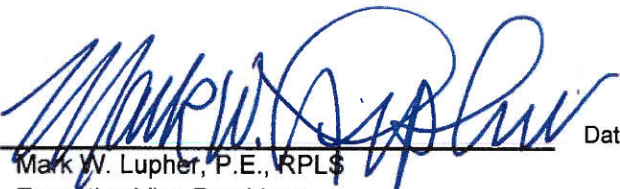
Authorized By:  Date: 8.21.14  
Mark W. Luper, P.E., RPLS  
Executive Vice President



2013-1128-10

**RGV Right-of-Way Services, LLC**

P.O. Box 720431  
McAllen, TX 78504

Invoice submitted to:  
TEDSI Infrastructure Group  
c/o Mr. Mark Lupher  
1201 E. Expressway 83  
Mission, TX 78572

July 31, 2014

In Reference To: Adam & Black Subdivision Project  
Invoice #10011

**Professional Services**

	<u>Hrs/Rate</u>	<u>Amount</u>
7/4/2014 File Management; Status Updates; Administrative Tasks	0.30 250.00/hr	75.00
7/10/2014 Telephone conference with J. Adams and M. Corbitt regarding Bradford parcel	0.20 250.00/hr	50.00
Draft and prepare memo to file regarding Bradford parcel	0.20 250.00/hr	50.00
7/25/2014 File Management; Status Updates; Administrative Tasks	0.30 250.00/hr	75.00
<b>For professional services rendered</b>	<b>1.00</b>	<b>\$250.00</b>
<b>Previous balance</b>		<b>\$5,175.00</b>
Accounts receivable transactions		
7/8/2014 Payment - Thank You No. 49074		(\$1,662.50)
<b>Total payments and adjustments</b>		<b>(\$1,662.50)</b>
Balance due		<u><u>\$3,762.50</u></u>

**TEDSI INFRASTRUCTURE GROUP**

2013-1128-10  
Project No. \_\_\_\_\_ Phase No. 400

Lump Sum     Approved     Hold

Hourly         Rejected         Process

Sign MWL        Date 8/21/14

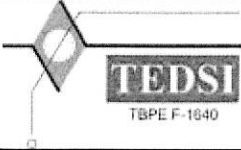
 <b>TEDSI INFRASTRUCTURE GROUP</b> <i>Consulting Engineers</i>		<h1>Project Progress Report</h1>	
<b>TO:</b>		<b>DATE:</b>	
Hidalgo County Drainage District No. 1		August 22, 2014	
<b>FROM:</b>		<b>TEDSI PROJECT NO.:</b>	
Mr. Mark Lupher, P.E., Project Manager		2013-1128-10	
<b>REFERENCE:</b>			
Adams & Black R.O.W. Acquisition			
<p>Progress Report for Invoice No. 20142034, July 01 to July 31, 2014</p>			

- Report by Week for Jason Adams
  - Week ending 07-04-2014
    - Coordinated with RGV Right of Way regarding latest R.O.W. acquisition information.
  - Week ending 07-11-2014
    - Coordinated with RGV Right of Way regarding latest R.O.W. acquisition information.
    - Met with Mr. Bradford regarding ROE. Received verbal ROE.
  - Week ending 07-18-2014
    - Coordinated with RGV Right of Way regarding latest R.O.W. acquisition information.
  - Week ending 07-25-2014
    - Coordinated with RGV Right of Way regarding latest R.O.W. acquisition information.
  - Week ending 08-01-2014
    - Coordinated with RGV Right of Way regarding latest R.O.W. acquisition information.
    - Prepared exhibit for surveyor & requested parcel sketch and metes and bounds for permanent and temporary easements.



MILE 11

1100 Feet

Proposed 48 Inch RCP

LA PERLA

ROSALINDA

MILE 3 1/2

1200 Feet

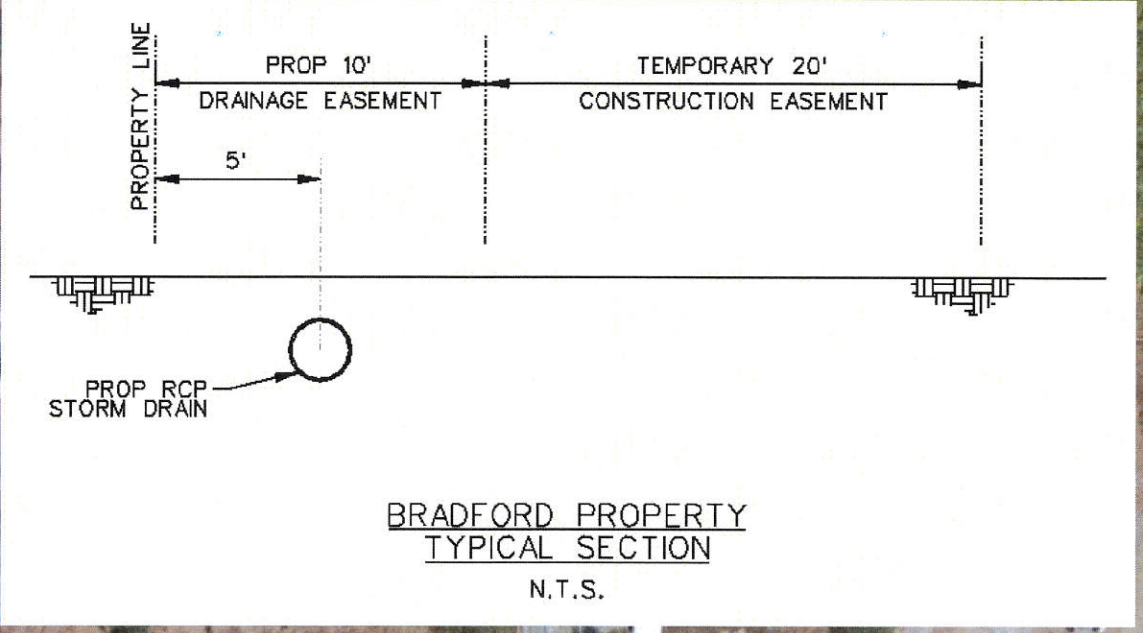
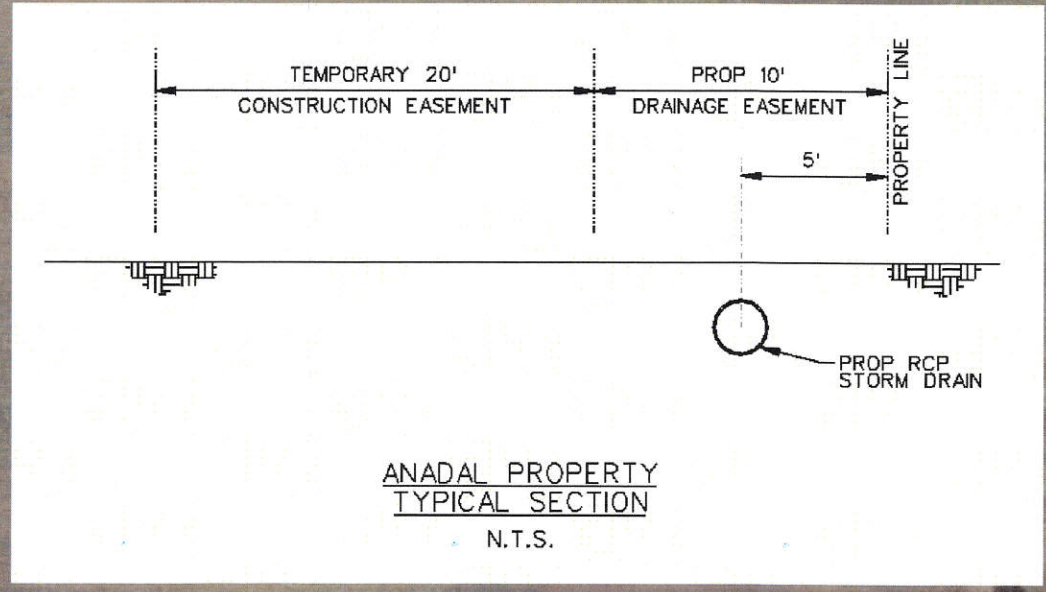

Proposed Manhole

450 Feet

Proposed Grate Inlets

BLACK

**Legend**

**Name**

- Grate Inlets
- W Manhole

**Name**

- 10ft Drainage Easement
- 20 ft Temp Construction Easement
- Pipe



July 7, 2014

INVOICE

Hidalgo County Drainage District No. 1  
 902 N. Doolittle  
 Edinburg, TX 78539

Attention: Sylvia Sanchez

Project Description: Repairs to Weir 4, Main Floodwater Channel in Willacy County

WA # 1	\$	36,601.00	TYPE: LS
WA # 2	\$	10,560.00	
WA # 3	\$	16,575.72	
<b>Total Authorized</b>	<b>\$</b>	<b>63,736.72</b>	

Invoice No.: U2167-01  
 Invoice Period: through 06-30-14

DESCRIPTION	AUTHORIZED LIMIT	PERCENT COMPLETE	INVOICED TO DATE	PREVIOUSLY INVOICED	AMOUNT THIS INVOICE
Development of preliminary engineering, final design, PS&E, construction bid documents, and contract award	\$ 63,736.72	87%	\$ 55,403.79	\$ -	\$ 55,403.79
<b>PROJECT TOTALS</b>	<b>\$ 63,736.72</b>	<b>87%</b>	<b>\$ 55,403.79</b>	<b>\$ -</b>	<b>\$ 55,403.79</b>
<b>AMOUNT DUE THIS INVOICE:</b>					<b>55,403.79</b>

*I hereby certify that this invoice is true and correct, and that all services indicated have been provided.*

S & B INFRASTRUCTURE, LTD.



Charlotte Lynne Teague, P.E.  
 Senior Project Manager

IN ACCORDANCE WITH OUR CONTRACT,  
 PLEASE REMIT: \$55,403.79

S & B INFRASTRUCTURE, LTD.  
 JPMORGAN CHASE BANK  
 ABA/ROUTING NUMBER 111000614  
 BANK ACCOUNT # 30801011378

Payment Due: August 6, 2014

Attachment:  
 PROGRESS REPORT # 1

**RECEIVED**  
 HIDALGO COUNTY  
 DRAINAGE DISTRICT #1

FEB 13 2014

9:10 AM/PM

BY: Rosa Arce



**PROJECT:** Repairs to Weir 4, Main Floodwater Channel in Willacy County  
*Preliminary Engineering, PS&E, Bid Documents & Award*

**OWNER:** Hidalgo County Drainage District No. 1

**S&B Job Number:** U2167

**PROGRESS REPORT NO. 1**

Progress Period: thru June 30, 2014

DESCRIPTION	ESTIMATED LINE ITEM BUDGET	PERCENT COMPLETE	INVOICED TO DATE	PREVIOUSLY INVOICED	AMOUNT DUE THIS INVOICE
<b>Work Authorization No. 1</b>					
Development of preliminary engineering, final design, PS&E, construction bid documents, and contract award.	\$36,601.00	90%	\$32,940.00	\$0.00	\$ 32,940.00
<b>Work Authorization No. 2</b>					
Perform design field surveying.	\$10,560.00	95%	\$10,032.00	\$0.00	\$ 10,032.00
<b>Work Authorization No. 3</b>					
Perform geotechnical investigations, analysis, and recommendations.	\$16,575.72	75%	\$12,431.79	\$0.00	\$ 12,431.79
<b>TOTALS</b>	<b>\$63,736.72</b>	<b>87%</b>	<b>\$55,403.79</b>	<b>\$0.00</b>	
<b>TOTAL INVOICE AMOUNT DUE \$</b>					<b>55,403.79</b>

# Project Memorandum

**HIDALGO COUNTY DRAINAGE DISTRICT NO. 1  
AGREEMENT FOR PROFESSIONAL SERVICES**

*Repairs to Weir 4, Main Floodwater Channel, Willacy County*

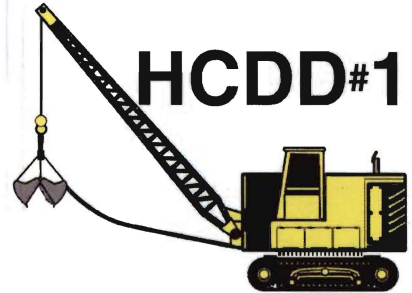

**S&BI Project No. U2167**

**13 August 2014**

**TO: Hidalgo County Drainage District No. 1**  
**Attn: Sylvia Sanchez**  
902 N. Doolittle  
Edinburg, Texas 78539

**FROM: *Sharlotte L. Teague, PE***  
Senior Project Manager  
S&B Infrastructure, Ltd. - McAllen

**SUBJECT: Invoices U2167-01 and U2167-02**

---

Sylvia – Attached are original invoices with electronic disk back-up for each.

As always, if you have any questions, please do not hesitate to contact me at anytime.

A handwritten signature in blue ink, appearing to be "S. Teague". The signature is written in a cursive style and is located in the center of the page, below the "FROM:" field.

attachments: as described above

cc: project files (U2167)

**RECEIVED**  
HIDALGO COUNTY  
DRAINAGE DISTRICT #1

FEB 13 2014

9:20 AM/PM

BY: Rosa Ace



August 4, 2014

INVOICE

Hidalgo County Drainage District No. 1  
 902 N. Doolittle  
 Edinburg, TX 78539

**Attention: Sylvia Sanchez**

Project Description: Repairs to Weir 4, Main Floodwater Channel in Willacy County

WA # 1 \$	36,601.00	TYPE: LS
WA # 2 \$	10,560.00	
WA # 3 \$	16,575.72	
<b>Total Authorized \$</b>	<b>63,736.72</b>	

Invoice No.: **U2167-02**  
 Invoice Period: through 07-31-14

DESCRIPTION	AUTHORIZED LIMIT	PERCENT COMPLETE	INVOICED TO DATE	PREVIOUSLY INVOICED	AMOUNT THIS INVOICE
Development of preliminary engineering, final design, PS&E, construction bid documents, and contract award	\$ 63,736.72	97%	\$ 61,905.77	\$ 55,403.79	\$ 6,501.98
<b>PROJECT TOTALS</b>	<b>\$ 63,736.72</b>	<b>97%</b>	<b>\$ 61,905.77</b>	<b>\$ 55,403.79</b>	<b>\$ 6,501.98</b>
<b>AMOUNT DUE THIS INVOICE:</b>					<b>6,501.98</b>

*I hereby certify that this invoice is true and correct, and that all services indicated have been provided.*

S & B INFRASTRUCTURE, LTD.

  
 Charlotte Lynne Teague, P.E.  
 Senior Project Manager

IN ACCORDANCE WITH OUR CONTRACT,  
 PLEASE REMIT: \$6,501.98

S & B INFRASTRUCTURE, LTD.  
 JPMORGAN CHASE BANK  
 ABA/ROUTING NUMBER 111000614  
 BANK ACCOUNT # 30801011378

Payment Due: September 3, 2014

Attachment:  
**PROGRESS REPORT # 2**

**RECEIVED**  
 HIDALGO COUNTY  
 DRAINAGE DISTRICT #1

FEB 13 2014

9:21 (AM) PM

BY: Rosa Arce



PROJECT: Repairs to Weir 4, Main Floodwater Channel in Willacy County  
*Preliminary Engineering, PS&E, Bid Documents & Award*

OWNER: Hidalgo County Drainage District No. 1

S&B Job Number: U2167

**PROGRESS REPORT NO. 2**

Progress Period: thru July 31, 2014

DESCRIPTION	ESTIMATED LINE ITEM BUDGET	PERCENT COMPLETE	INVOICED TO DATE	PREVIOUSLY INVOICED	AMOUNT DUE THIS INVOICE
<b>Work Authorization No. 1</b>					
Development of preliminary engineering, final design, PS&E, construction bid documents, and contract award.	\$36,601.00	95%	\$34,770.05	\$32,940.00	\$ 1,830.05
<b>Work Authorization No. 2</b>					
Perform design field surveying.	\$10,560.00	100%	\$10,560.00	\$10,032.00	\$ 528.00
<b>Work Authorization No. 3</b>					
Perform geotechnical investigations, analysis, and recommendations.	\$16,575.72	100%	\$16,575.72	\$12,431.79	\$ 4,143.93
<b>TOTALS</b>	<b>\$63,736.72</b>	<b>97%</b>	<b>\$61,905.77</b>	<b>\$55,403.79</b>	
<b>TOTAL INVOICE AMOUNT DUE \$</b>					<b>6,501.98</b>



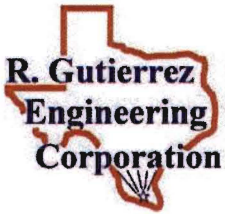

**Professional Engineers & Land Surveyors**

130 E. PARK AVENUE • PHARR, TEXAS 78577

(TEL) 056-782-2557 • (FAX) 056-782-2558

Engineering Firm F - 486 • Surveying Firm #101650-00

Invoice Number 3663

Date 8/14/2014

Due on receipt

# Invoice

Hidalgo County Drainage District No. 1  
Godfrey Garza, Jr.  
902 N. Doolittle Road  
Edinburg, TX 78542

**Project: R-K Rural Drain Development Prog.- Pct2-2**

Project No.: ENG13.001  
Contract No.: WA#3  
PO No. 624631-R

Const. Cost  
% of Const. Cost  
Billing Fee 11,328.08

<u>Phase</u>	<u>Phase Fee</u>	<u>% Complete</u>	<u>Fee Earned</u>	<u>Prior Billing</u>	<u>Current Fee</u>
Northside Village	2,832.02	62.99%	1,783.93	1,524.60	259.33
Hidden Valley Estates	2,832.02	0.00%			0.00
Minnesota Meadows	2,832.02	0.00%			0.00
Seminole Valley	2,832.02	0.00%			0.00

**Balance Due**

**\$259.33**

# INVOICE

**CONSULTANTS \* ENVIRONMENTAL \* FACILITIES \* INFRASTRUCTURE**

**BILLING DATE :**  
6/23/2014

**PROJECT :**  
AMD1401900  
Hidden Valley - Northside Village

**CLIENT :**  
A13388 R Gutierrez Engineering Corp.



**Ramiro Gutierrez**  
**R Gutierrez Engineering Corp.**  
**130 East Park Avenue**  
**Pharr, TX 78577**

**REMITTANCE ADDRESS:**  
**RABA KISTNER, INC.**  
**P.O. BOX 971037**  
**DALLAS, TX 75397-1037**

**PHONE (210) 699-9090**

## CONSULTING SERVICES

### INVOICE SUMMARY INFORMATION

Subdivision Area Drainage Improvements Hidalgo County Drainage  
District No. 1 - Alamo, Hidalgo County, Texas  
Project Administration 10% - RKCI Proposal No. PMD14-021-00  
\*\*RETMC\*\*

**FOR PROFESSIONAL SERVICES RENDERED THROUGH: 6/7/2014**

SERVICE DATE	05/14/2014	235.75
SERVICE DATE	06/07/2014	23.58

**AMOUNT DUE THIS INVOICE \*\*** 259.33

**THIS IS AN INTERIM INVOICE UNLESS OTHERWISE NOTED**

RK PROJECT MANAGER: JORGE L PEREZ  
CLIENT PHONE: 956-782-2557

#### PROJECT ACCOUNTS RECEIVABLE SUMMARY

Amount Due This Invoice	\$	259.33
Total of Previous Invoices - Currently Unpaid		<u>2,508.00</u>
Total Due And Payable	\$	2,767.33

**BILLING DATE :**  
6/23/2014

**PROJECT :**  
AMD1401900      A13388  
Hidden Valley - Northside Village  
R Gutierrez Engineering Corp.

**SALARY / EXPENSE DETAILED BACKUP**

DESCRIPTION	REMARKS	QUANTITY	RATE	AMOUNT
05/14/2014				
CMT FIELD & LABORATORY TESTING				
VEHICLE TRAVEL	M14-011508	1.00	45.000	45.00
CHARGE				
FIELD DENSITY	M14-011508	5.00	19.750	98.75
TEST-UTILITY BACKFILL				
TECHNICIAN	M14-011508	2.00	46.000	92.00
TIME-DENSITY				
TESTING-UTILITY				
BACKFILL				
			<b>SUBTOTAL</b>	<b>235.75</b>
06/07/2014				
CMT FIELD & LABORATORY TESTING				
TECHNICAL REVIEW &	10%	1.00	23.580	23.58
ADMIN				
			<b>SUBTOTAL</b>	<b>23.58</b>
			<b>** TOTAL PROJECT AMD1401900</b>	<b>259.33</b>

# FIELD TEST REPORT

Soil/Base Material Nuclear Density Test

ATTN.: MR. RAMIRO GUTIERREZ, P.E., PRESIDENT  
 TO: R. GUTIERREZ ENGINEERING CORPORATION  
 130 EAST PARK AVENUE  
 PHARR, TEXAS 78577



Raba Kistner Consultants Inc.  
 800 East Hackberry  
 McAllen, Texas 78501  
 (956) 682-5332 • FAX(956) 682-5487  
 www.rkci.com  
 TBPE Firm F-3257

PROJECT NO.: AMD14-019-00  
 DATE OF TEST: 05/14/2014  
 ASSIGNMENT NO.: M14-011508  
 REPORT VERSION: A  
 SHEET NUMBER: 1 of 1  
 TECHNICIAN: VICTOR SALINAS IIII

PROJECT: Hidden Valley - Northside Village Subd. Area Drainage  
 Imp., Hidalgo Cnty. Drainage Dist. No. 1, Alamo, Texas

TEST NO.	TEST LOCATION	SOIL TYPE	LIFT NO. /DEPTH	MOISTURE CONTENT (%)	DRY DENSITY (PCF)	PERCENT PROCTOR (%)	CONFORM
	<u>Along Sunshine Drive</u>						
18	Near STA.: 20 + 16, on Centerline	3	FINAL	12.0	116.2	98.3	Yes
	<u>Along El Dora Road</u>						
19	Near STA.: 20 + 14, on Centerline	3	FINAL	11.8	117.3	99.2	Yes
20	Near STA.: 26 + 51, on Centerline	3	FINAL	11.5	116.4	98.5	Yes
21	Near STA.: 15 + 39, on Centerline	3	FINAL	12.1	116.1	98.2	Yes
22	Near STA.: 12 + 57, on Centerline	3	FINAL	11.3	116.5	98.6	Yes

CURVE ID.	SOIL TYPE	OPTIMUM MOISTURE (%)	MAX. DRY DENSITY (PCF)	REQUIRED MOISTURE (%)	REQUIRED DENSITY (%)	LAB TEST PROCEDURE
3	Light Brown Caliche w/Gravel (Proposed Flexible Base Material) (PI:2)	11.0	118.2	9-13	98	TEX-113-E

REFERENCE: Pavement Section/Flexible Base

FIELD TEST PROCEDURE: ASTM D 6938

GAUGE NUMBER: 4

REMARKS: Lift and station information is provided by contractor.

PERSON NOTIFIED: Mr. Juan Uribe w/R. Gutierrez Engineering Corp.

CONTRACTOR: Hidalgo County Precinct No. 2

\* - Indicates noncompliance with specifications.

NOTICE: Raba Kistner Consultants, Inc. considers the data and information contained in this report to be proprietary. This information is intended only for the use of the recipient(s) named herein. Test results presented herein relate only to those items tested. This document and any information contained herein shall not be disclosed and shall not be duplicated or used in whole or in part for any purpose other than to validate test results without written approval from Raba Kistner Consultants, Inc.

COPIES TO: Above (1)

- rgutierrez@rgec.net (1)
- hlugo@rgec.net (1)
- javier@rgec.net (1)
- efrainjr@rojasheavygroup.com (1)
- rconstruction@rojasheavygroup.com (1)
- jvrvento@rojasheavygroup.com (1)
- g.g@hccd1.org (1)

RABA KISTNER CONSULTANTS, INC.

BY: Carlos Ceballos Jr.  
 05/15/2014



Updated By: MMR 5/15/2014 1:52:48PM

Austin • Brownsville • Dallas • El Paso • Houston • McAllen • Mexico • New Braunfels • Salt Lake City • San Antonio



# HIDALGO COUNTY DRAINAGE DISTRICT NUMBER ONE

502 NORTH DOOLITTLE

EDINBURG, TEXAS 78542

(956) 292-7080

FAX (956) 292-7089



GODFREY GARZA, JR.  
MANAGER

## INVOICE PROCESSING CHECKLIST

Date Received:

8/15/2014

PO# 624631-R

Engineer/Firm Name:

R. Gutierrez Engineering

Project Name/Number:

2012 Bond Ref. PK Rural Drainage Dev.

Invoice No:

#31663

Logged in and Scanned:

11:31 8/15

By: R. Arce

Forwarded to: Joey Garza

Engineer	Name	Date	Comment
Scope of work reviewed			

Accounting	Name	Date	Comment
Encumbrance			
Purchase Order Attached			
Audit			
Final Approval for Agenda			

	Name	Date	Comment
Placed on Agenda			

Additional Comments: \_\_\_\_\_  
 \_\_\_\_\_  
 \_\_\_\_\_  
 \_\_\_\_\_

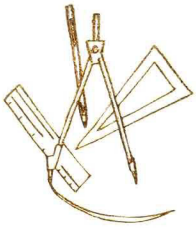

August 4, 2014

Mr. Godfrey Garza – Executive Director  
**Attn: Ms. Lora Briones – Chief Financial Officer**  
Hidalgo County Drainage District #1  
902 N. Doolittle  
Edinburg, Texas 78542

**RE: Work Authorization #4 on Mission Inlet Recertification Project – Progress Report**

**Job #130204**  
**P.O. #624010**

Dear Mr. Garza,

Attached for your review and approval is our invoice for the services rendered during the month of May 2014 on the subject referenced project.

The following is attached:

- L&G's Invoice # 11324908
  - CD w/ Inv Back-Up (Elec File Submit)
    - Task 8 & Task 9 (together)
    - Task 12, Task 13

TASK		% COMPL
FC13001 – Task 1 ~ Compilation & Review of Public Records (Appraisal District, Hidalgo County Records, HCDD #1 Easement & Quit Claim Deeds)	L&G	100%
<b>Task Complete – See progress report dated February 4, 2014</b>		
FC16104 – Task 2 ~ Georeferencing of Parcels & Survey Plat Information for Overall Existing Floodway/Levee Easement Map	L&G	100%
<b>Task Complete – See progress report dated February 4, 2014</b>		
FC11001 – Task 3 ~ Sketching of Parcels & Survey Plats for Floodway/Levee Easements Identified w/ No Survey Info (Using Easement Claim Parameters)	L&G	100%
<b>Task Complete – See progress report dated February 4, 2014</b>		
FC10201 – Task 4 ~ Researching & Cross Referencing Latest HC Appraisal District Info w/ Documented Floodway/Levee Easement Data	L&G	100%
<b>Task Complete – See progress report dated February 4, 2014</b>		
FC16101 – Task 5 ~ Calculation of Areas of Existing Levee & Floodway Easements for Potential Release of Lien	L&G	100%
<b>Task Complete – See progress report dated February 4, 2014</b>		
FC10205 – Task 6 ~ Segmenting, Organizing & Databasing (Electronic & Hard Copies) Existing HCDD #1 Data (Section I, II and III Project Binders)	L&G	100%

<b>Task Complete – See progress report dated February 4, 2014</b>		
FC10204 – Task 7 ~ Support to HCDD #1 on Project Development (i.e. Meetings w/ Land Owners, Coord. w/ County, Coord. w/ Cities, etc.)	L&G	100%
<b>Task Complete – See progress report dated February 4, 2014</b>		
FC16106 – Task 8 ~ Coord. & Supp. to CSE - HEC-HMS, RAS, & SWMM Model	L&G	95.1%
<b>Update</b> – L&G has continued coordination with CSE in the development of the proposed condition model for the Mission Inlet. Various options have been discussed with the design team and we are working to propose the most feasible option for implementation by HCDD#1. Two (2) major meetings (L&G, CSE, HCDD #1) were held on 7/2/2014 and 7/23/2014 for proposed improvements collaboration.		
FC16170 – (SUB) Task 9 ~ Phase II – Proposed Condition H&H Modeling Analysis	CSE	94.2%
<b>Update</b> – See progress report from CSE titled “Mission Inlet Recertification Project – Phase II ~ Monthly Progress Report No.#5 – July 2014” for a detailed explanation of the work that has been completed during this billing period.		
FC10203 – Task 10 ~ Coord. w/ USIBWC/USACE for Cert. of Levee Sections	L&G	10.2%
<b>No Update</b> – See Progress Report Date March 31, 2014		
FC16107 – Task 11 ~ Coord. w/ FEMA for Accreditation of Levee	L&G	10.4%
<b>No Update</b> – See Progress Report Date March 31, 2014		
FC16109 – Task 12 ~ Development of Final Proposed Conditions Graphic Files (Location Specific Exhibits) In Concert w/ H&H Modeling (Incl. Structure Sizing)	L&G	25%
<b>Update</b> – L&G created various graphic files in concert with CSE for the purpose of two (2) major meetings (L&G, CSE, HCDD #1) held on 7/2/2014 and 7/23/2014. All graphic files were incorporated into a Powerpoint document denoting the best alternatives for proposed improvements.		
FC11004 – Task 13 ~ Development of Final Proposed Conditions Schematic w/ Typical Sections (For Usage in PS&E Development)	L&G	25%
<b>Update</b> – L&G has utilized the various graphic files created in concert with CSE for the purpose of two (2) major meetings (L&G, CSE, HCDD #1) held on 7/2/2014 and 7/23/2014 for schematic generation (exhibits). All graphic files were incorporated into a Powerpoint document denoting the best alternatives for proposed improvements.		
<b>Direct Expenses</b>	L&G	54.8%
<b>Update</b> –L&G has produced various copies, both 8 ½ x 11 and 11 x 17, for Final Proposed Conditions Reports produced for HCDD#1, Precinct 4 and for use during various meetings regarding this project.		

Should you have any questions regarding this submittal or would like clarification on any aspect of the project, please do not hesitate to call me at (956) 583-7117.

Sincerely,

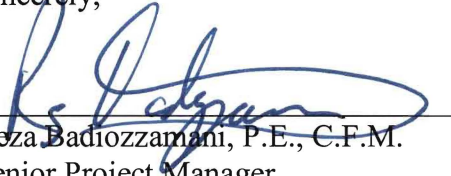

Reza Badiozzamani, P.E., C.F.M.  
Senior Project Manager  
L&G Engineering

**L & G Consulting Engineers Inc**  
**2100 W. Expressway 83**  
**Mercedes, TX 78570**  
**(956)565-9813 Fax (956)565-9018**

**INVOICE#: 11324908**  
**INVOICE DATE: 7/31/2014**

**RECEIVED**  
 HIDALGO COUNTY  
 DRAINAGE DISTRICT #1

AUG 05 2014

8:39 AM / PM

BY: Rosa Arce

**BILL TO: 87**  
 Hidalgo County Drainage District#1  
 902 N. Doolittle  
 Edinburg, TX 78542

**JOB:130204**  
 Mission Inlet Recertification Project  
 WA#4  
 P.O.#624010

DESCRIPTION	CONTRACT	PREVIOUS APPLICATIONS	CURRENT COMPLETED	TOTAL COMPLETED	% COMPL	BALANCE TO FINISH
<b>Engineering services for the month of July 2014.</b>						
FC 13001 - Task 1 - Compilation & Review of Public Records	12,004.46	12,004.46		12,004.46	100.0	-
FC 16104 - Task 2 - Georeferencing of Parcels & Survey Plat	13,655.78	13,655.78		13,655.78	100.0	-
FC 11001 - Task 3 - Sketching of Parcels & Survey Plats for F	13,655.78	13,655.78		13,655.78	100.0	-
FC 10201 - Task 4 - Researching & Cross Referencing Latest HC	9,878.66	9,878.66		9,878.66	100.0	-
FC 16101 - Task 5 - Calculation of Areas of Existing Levee &	10,429.26	10,429.26		10,429.26	100.0	-
FC 10205 - Task 6 - Segmenting, Organizing & Databasing	8,753.46	8,753.46		8,753.46	100.0	-
FC 10204 - Task 7 - Support to HCDD#1 on Project Development	58,837.20	58,837.20		58,837.20	100.0	-
FC 16106 - Task 8 - Coordination and Support to Hydraulic Eng	39,691.72	32,363.62	5,371.02	37,734.64	95.1	1,957.08
FC 16170 - Task 9 - SUB/Phase II - Proposed Conditions H&H Mo	394,813.00	316,849.68	55,236.72	372,086.40	94.2	22,726.60
FC 10203 - Task 10 - Coordination with USIBWC/USACE for Certi	19,270.72	1,969.59		1,969.59	10.2	17,301.13
FC 16107 - Task 11 - Coordination with FEMA for Accreditation	11,267.32	1,169.25		1,169.25	10.4	10,098.07
FC 16109 - Task 12 - Development of Proposed Conditions Graph	12,830.52		3,207.63	3,207.63	25.0	9,622.89
FC 11004 - Task 13 - Development of Final Proposed Conditions	33,989.56		8,497.39	8,497.39	25.0	25,492.17
FC 16401 - Task 14 - Preliminary Engineering Report Summarizi	18,782.74			0.00	0.0	18,782.74
FC 16108 - Task 15 - Coordination and Support to Hydraulic En	21,321.50			0.00	0.0	21,321.50
FC 11040 - Task 16 - Sub/Phase III - Conditional Letter of Ma	212,227.00			0.00	0.0	212,227.00
FC 16301 - Task 17 - Development of Final Binder w/All Data.	15,768.92			0.00	0.0	15,768.92
	907,177.60	479,566.74	72,312.76	551,879.50		355,298.10
Direct Expenses	16,250.00	6,998.82	1,900.00	8,898.82	54.8	7,351.18
	16,250.00	6,998.82	1,900.00	8,898.82		7,351.18
<b>TOTALS:</b>	<b>923,427.60</b>	<b>486,565.56</b>	<b>74,212.76</b>	<b>560,778.32</b>	<b>60.7</b>	<b>362,649.28</b>

ORIGINAL CONTRACT SUM	\$ 923,427.60
CHANGE BY CHANGE ORDER	\$ 0.00
CONTRACT SUM TO DATE	\$ 923,427.60
TOTAL COMPLETED TO DATE	\$ 560,778.32
LESS PREVIOUS INVOICES	\$ 486,565.56
<b>CURRENT PAYMENT DUE</b>	<b>\$ 74,212.76</b>

  
 PROJECT MANAGER'S SIGNATURE

L&G Consulting Engineers, Inc  
 2100 W. Expressway 83  
 Mercedes, Texas 78570  
 (956) 565-9813

**Project Workhour Report**  
 Mission Inlet Recert. Project WA#4  
 Reference: Inv#11324908  
 Date: 07/31/2014  
 P.O.#624010

	Hrs		Rate	Total
Senior Project Manager	10.00	X	212.59	\$2,125.90
Senior Engineer	34.00	X	175.07	\$5,952.38
Design Engineer	48.00	X	112.55	\$5,402.40
Senior Engineer Tech	46.00	X	78.16	\$3,595.36
ROW Administrator	0.00	X	106.29	\$0.00
Admin/Clerical	0.00	X	56.27	\$0.00

**Grand Total of Hours** \$ 17,076.04  
 (Difference due to rounding hours) \$ -

<b>Invoice Summary</b>				
Man Hours				\$ 17,076.04
Sub Contract				\$ 55,236.72
<small>(See Attached Sub Invoice for Man Hour Breakdown)</small>				
<b>Direct Expenses</b>	<b>Current</b>		<b>Rate</b>	
	<b>Units</b>			
30 ft. Long by 3 ft. Tall Schematic Exhibit (90sq. Ft) @\$5.00/sq. ft	0	X	1,350.00	\$ 900.00
8.5 X 11 Copies (i.e. Section I, II, III Inventory Binders) - (4,000 units)	0	X	2,000.00	\$ 1,000.00
Travel	0	X	2,500.00	\$ -
				\$ 1,900.00
			(Difference due to rounding)	\$ -

**Total Per Invoice Submitted** \$ 74,212.76





2299 Lone Star Drive, Ste 239  
 Sugar Land, Texas 77479  
 (713) 782-3811

**INVOICE**

Engineering Services  
 Mission Inlet Recertification Project - Phase II

L&G Engineering 2100 W. Expressway 83 Mercedes, Texas 78570 Attention: Mr. Reza Badiozzamani, P.E.	CSE Invoice Number: 201431 CSE Project Number: LG2013013 Invoice Period: 06/26/2014 Through 07/25/2014 Invoice Date: July 25, 2014
---	---

<table border="1"> <tr> <td><b>Contract Amount</b></td> <td><b>Contract Amount Remaining</b></td> </tr> <tr> <td>\$607,040.00</td> <td>\$234,953.60</td> </tr> </table>		<b>Contract Amount</b>	<b>Contract Amount Remaining</b>	\$607,040.00	\$234,953.60								
<b>Contract Amount</b>	<b>Contract Amount Remaining</b>												
\$607,040.00	\$234,953.60												
Employee Classification	Rate	Previous		This Period		To Date							
		Hr	Total	Hr	Total	Hr	Total						
Project Manager	\$178.36	238.0	\$42,449.68	2.0	\$356.72	240.0	\$42,806.40						
Project Engineer	\$164.64	1,400.0	\$230,496.00	320.0	\$52,684.80	1,720.0	\$283,180.80						
GIS Specialist	\$137.20	320.0	\$43,904.00	16.0	\$2,195.20	336.0	\$46,099.20						
<b>Subtotal</b>			<b>\$316,849.68</b>		<b>\$55,236.72</b>		<b>\$372,086.40</b>						
Deren Li, Ph.D., P.E., D.WRE Project Manager						<table border="1"> <tr> <td><b>TOTAL FEE EARNED:</b></td> <td>\$372,086.40</td> </tr> <tr> <td><b>LESS PREVIOUSLY INVOICED:</b></td> <td>\$316,849.68</td> </tr> <tr> <td><b>TOTAL AMOUNT DUE THIS INVOICE:</b></td> <td><b>\$55,236.72</b></td> </tr> </table>		<b>TOTAL FEE EARNED:</b>	\$372,086.40	<b>LESS PREVIOUSLY INVOICED:</b>	\$316,849.68	<b>TOTAL AMOUNT DUE THIS INVOICE:</b>	<b>\$55,236.72</b>
<b>TOTAL FEE EARNED:</b>	\$372,086.40												
<b>LESS PREVIOUSLY INVOICED:</b>	\$316,849.68												
<b>TOTAL AMOUNT DUE THIS INVOICE:</b>	<b>\$55,236.72</b>												

**Mission Inlet Recertification Project – Phase II**  
**Monthly Progress Report No. #5 – July 2014**

Period of Coverage: July 2014  
Date of Submittal: July 25, 2014  
Submitted To: Reza Badiozzamani, P.E.  
Prepared By: Civil Systems Engineering Inc.

---

Phase II for the Mission Inlet Recertification Project is to evaluate alternative components and improvement plans to Mission Inlet to reclaim portion of the lands within the effective floodplain and to provide a higher flood protection to the existing developments. This study covers the following activities:

**I. ALTERNATIVE COMPONENT AND PLAN ANALYSIS**

1. Coordination with HCDD1, L&G, FEMA, and IBWC
2. Proposed conditions HEC-HMS modeling analysis
3. Proposed conditions HEC-RAS modeling analysis
4. Perform 1D and 2-D SWMM dynamic modeling analysis
5. Perform constrain and opportunities analysis.
6. Formulate alternative plans for the project.
7. Perform detailed hydrologic and hydraulic modeling analysis to evaluate and optimize alternative plans and recommend a preferred proposed plan for the project.
8. Perform flood hazard mapping using the resulting water surface data and the LiDAR topographic data for the recommend plan.
9. Cost estimation.
10. Prepare a Technical Report to summarize the assumptions, methodology, and results for the project.

**II. CONDITIONAL LETTER OF MAP REVISION (CLOMR)**

1. Coordination with FEMA and other relevant agencies.
2. Prepare MT-2 application forms.
3. Prepare narrative on project and submittal.
4. Prepare hydrologic computations results along with digital files of computer models used.
5. Prepare hydraulic computations along with the digital files of computer models used.
6. Prepared certified topographic map with floodplain and floodway delineations.
7. Prepare annotated FEMA FIRM and/or FBFM to reflect changes due to the proposed to the Mission Inlet drainage system.
8. Address FEMA comments

## **PROGRESS TO REPORT FOR THIS PERIOD**

### **I. ALTERNATIVE COMPONENT AND PLAN ANALYSIS**

#### Activity 1 – Coordination and meetings

Coordination on alternative improvement plans evaluation and optimization

#### Activity 2 – Proposed conditions HEC-HMS modeling analysis

Completed hydrologic modeling analysis

#### Activity 3 – Proposed conditions HEC-RAS modeling analysis

Developed and performed 1-D HEC-RAS modeling analysis

#### Activity 4 – 1D and 2D SWMM modeling analysis

Alternative plan 2D SMMM modeling analysis and optimization

#### Activity 5 – Perform constrains and opportunities analysis

Identified project constraints and opportunities

#### Activity 6 – Alternative plan formulation

Formulated a set of alternative plans based individual component measure evaluation

#### Activity 7 – Alternative evaluation and optimization

Performed alternative plan evaluation and optimization.

#### Activity 8 – Flood hazard mapping

Performed flood plain and hazard depth mapping for both open and closed gate contiditions.

#### Activity 9 – Cost estimation

#### Activity 10 – Technical report.

Preparing draft technical report.

## **II. CONDITIONAL LETTER OF MAP REVISION (CLOMR)**

Activity 1 -Coordination with FEMA and other relevant agencies.

Activity 2 - Prepare MT-2 application forms.

Activity 3 -Prepare narrative on project and submittal.

Activity 4 - Prepare hydrologic computations results along with digital files of computer models used.

Activity 5 - Prepare hydraulic computations along with the digital files of computer models used.

Activity 6 - Prepared certified topographic map with floodplain and floodway delineations.

Activity 7 - Prepare annotated FEMA FIRM and/or FBFM to reflect changes due to the proposed to the Mission Inlet drainage system.

Activity 8 - Address FEMA comments

AI-46382

5.

**DRAINAGE - CONSENT**

**Meeting Date:** 09/09/2014

Submitted For: Lora Briones

Submitted By: Lora Briones, DRAINAGE  
DISTRICT

Department: DRAINAGE DISTRICT

---

Information

CAPTION

Approval of Budget Line Item transfers by Object within of the 2013 Bond Series

BACKGROUND

---

Form Review

<b>Inbox</b>	<b>Reviewed By</b>	<b>Date</b>
Budget & Management	Debbie Tamez	09/05/2014 02:43 PM
Final Approval	Monica Badillo	09/05/2014 05:45 PM
Form Started By: Lora Briones		Started On: 09/05/2014 01:37 PM
	Final Approval Date: 09/05/2014	